

Crestron TST-600-SMK  
Swivel Mount Kit for TST-600-DS

---

Installation Guide



Product warranty can be found at [www.crestron.com/warranty](http://www.crestron.com/warranty).

The specific patents that cover Crestron products are listed at [patents.crestron.com](http://patents.crestron.com).

Crestron, the Crestron logo, and Cresnet are either trademarks or registered trademarks of Crestron Electronics, Inc. in the United States and/or other countries. Other trademarks, registered trademarks, and trade names may be used in this document to refer to either the entities claiming the marks and names or their products. Crestron disclaims any proprietary interest in the marks and names of others. *Crestron is not responsible for errors in typography or photography.*

This document was written by the Technical Publications department at Crestron.  
©2014 Crestron Electronics, Inc.

# Contents

<b>Swivel Mount Kit for TST-600-DS: TST-600-SMK</b>	<b>1</b>
Introduction .....	1
Setup .....	2
Supplied Hardware .....	2
Installation .....	3
Resources .....	7
Further Inquiries .....	7
Future Updates .....	7



# Swivel Mount Kit for TST-600-DS: TST-600-SMK

---

## Introduction

The TST-600-SMK Swivel Mount Kit is an optional accessory for the Crestron® TST-600-DS TableTop Docking Station and the TST-600 and TST-602 Wireless Touch Screens. The swivel mount provides a means of permanently mounting the docking station to a flat countertop or tabletop surface\* while still allowing for optimal positioning. The swivel range can be customized using optional limit screws, with a maximum 330 degree rotation allowed.

\* Surface thickness must be 1 inch (25 mm) minimum to 1 3/8 inches (35 mm) maximum.

## Setup

### Supplied Hardware

The hardware supplied with the TST-600-SMK is listed in the following table.

#### *Supplied Hardware for the TST-600-SMK*

DESCRIPTION	PART NUMBER	QUANTITY
Assembly, Swivel Stop Plate and Screw	4504353	1
Metal Washer, Keyed, Swivel Stop	4506321	1
Cork/Rubber Washer, Custom, Swivel	2017614	1
Rubber Washer, Custom, Swivel	2017615	1
Felt Washer, Die-Cut with Adhesive	2024711	1
Screw, #08-32 x 1/8", Steel, Socket Head	2017634	2
Washer, Flat Steel, 7/8-A, Narrow, 15/16" Inner Diameter, 1.75" Outer Diameter, 0.134" Thick	2017633	1
Nut, #7/8"-14, 1 15/16" Hex Diameter, 31/64" H, Steel, Zinc	2017632	1
Screw, #08-8B x 1/2", Steel, Pan, Phil	2017784	6
Screw, #06-32 x 3/16", Steel, Flat, Phil, Zinc	2007202	3
Overlay, Template, Table Cutout	4517324	1

## Installation

To attach the TST-600-SMK Swivel Mount Kit to the TST-600-DS (included with the TST-600 and TST-602) and install the assembly on a suitable mounting surface, refer to the following procedures.

### ***TST-600-SMK/TST-600-DS Assembly***

To assemble the swivel mount, perform the following procedure:

1. Attach and secure the swivel mechanism tube (4517277) to the bottom of the TST-600-DS using the three #06-32 x 3/16" screws (2007202) included with the TST-600-SMK, as shown in the following illustration.

#### ***Attaching Swivel Mechanism Tube to TST-600-DS***

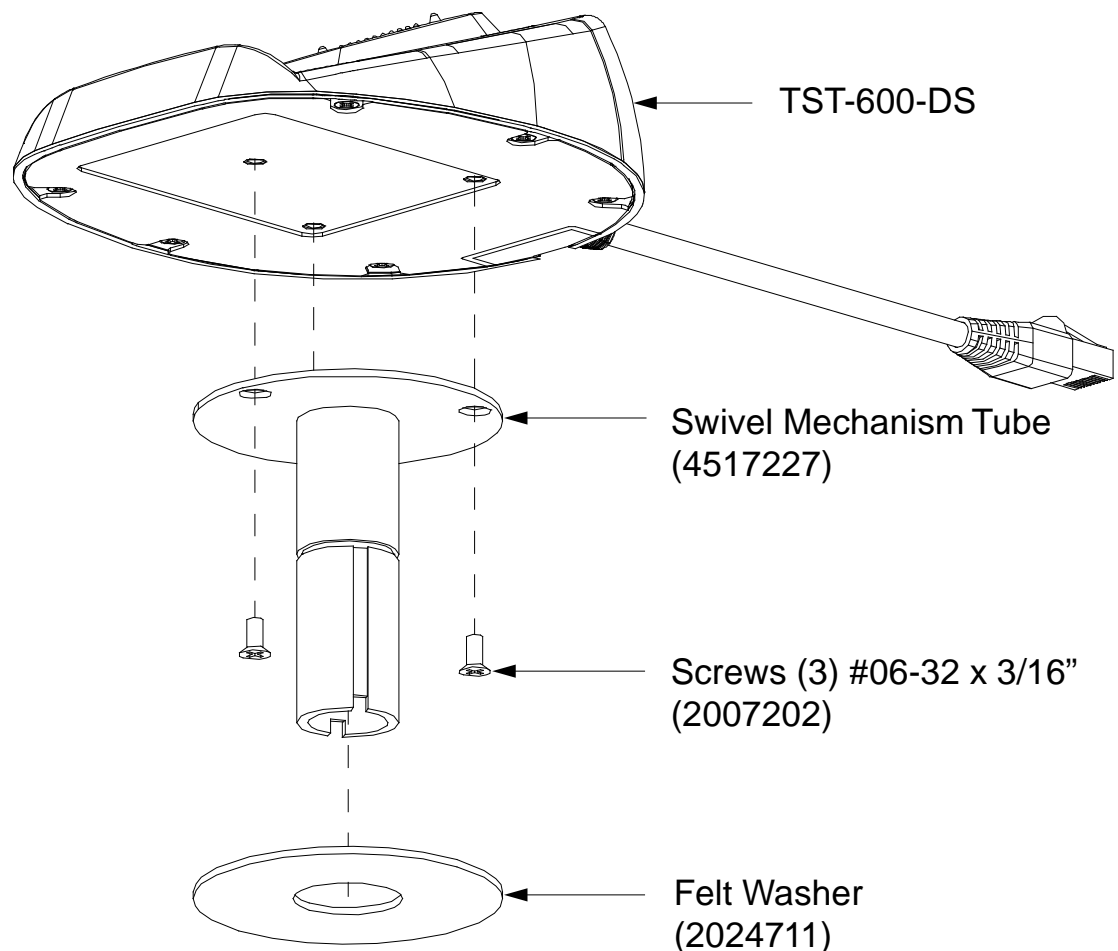

2. Remove the paper liner from the felt washer (2024711) and attach the washer to the bottom of the swivel mechanism tube (4517227). Refer to the illustration above.

3. Prepare the mounting surface using the template (4517324) provided with the kit. The center hole diameter for the swivel mechanism tube should be 7/8" (22 mm) minimum, 15/16" (24 mm) maximum. Position the template so the edge indicated as the front edge of the table or surface aligns with the desired front position of the TST-600-DS. Observe the dashed line indicating the front edge of the TST-600-DS to ensure the device does not overhang the mounting surface.
4. Using the six mounting holes on the swivel stop plate (4504353) as a template, drill pilot holes 0.093" (2 mm) minimum, 0.115" (3 mm) maximum diameter and no deeper than 0.35" (9 mm). Attach the swivel stop plate to the bottom of the mounting surface using the six #08-8B x 1/2" screws (2017784) provided with the kit. Pass the swivel mechanism tube down through the mounting hole and stop plate.

---

**NOTE:** The swivel stop plate has a permanently installed limiting screw to prevent the swivel mechanism from spinning continuously in one direction and tangling the cable attached to the touch screen.

---

5. Slide the provided hardware up onto the swivel tube in the order indicated in the illustration on the following page.

---

**NOTE:** The keyed metal washer (4506321) fits onto the swivel mechanism tube in one of two orientations. Orient the tab on the washer to face away from the permanently installed limiting screw in the swivel stop plate.

---

6. Tighten and adjust the provided #7/8"-14 nut (2017632) onto the swivel tube to achieve the desired resistance in swivel assembly motion. A flat tool (such as a large flat head screwdriver) may be used in the slot on the bottom of the swivel mechanism tube to hold the tube still while tightening the nut.



**Swivel Mechanism Assembly**

Table or Mounting Surface  
(Front Edge)

Mounting Hole

Bottom Side of Table  
or Mounting Surface

Swivel Mechanism Tube  
(4517227)

Slot in Tube

Mounting Holes (6)  
In Swivel Stop Place

Screws (6) #08-8B x 1/2"  
(2017784)

Swivel Stop Plate  
(4504353)

Cork/Rubber Washer  
(2017614)

Screws (2) #08-32 x 1/8"  
(2017634)

Keyed Metal Washer  
(4506321)

Rubber Washer  
(2017615)

Flat Steel Washer  
(2017633)

Nut #7/8"-14, Steel  
(2017632)

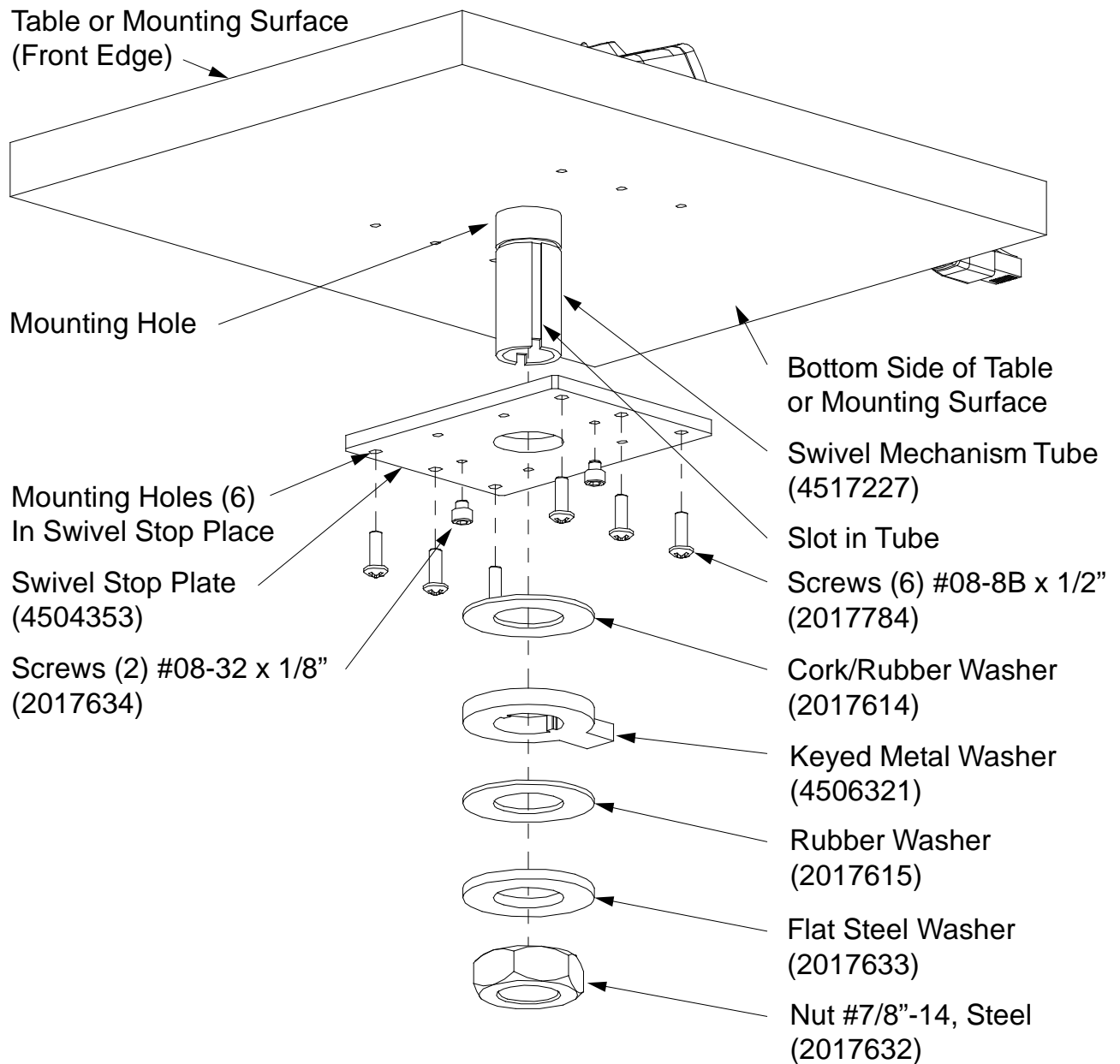

### ***Customize Range***

Aside from the permanently installed limiting screw attached to the swivel stop plate, two additional #08-32 x 1/8" limiting screws (2017634) are included with the TST-600-SMK. These screws are provided to set a custom range for swivel movement. Refer to the following illustrations for their application.

#### ***Swivel Stop Plate with Permanent Limiting Screw***

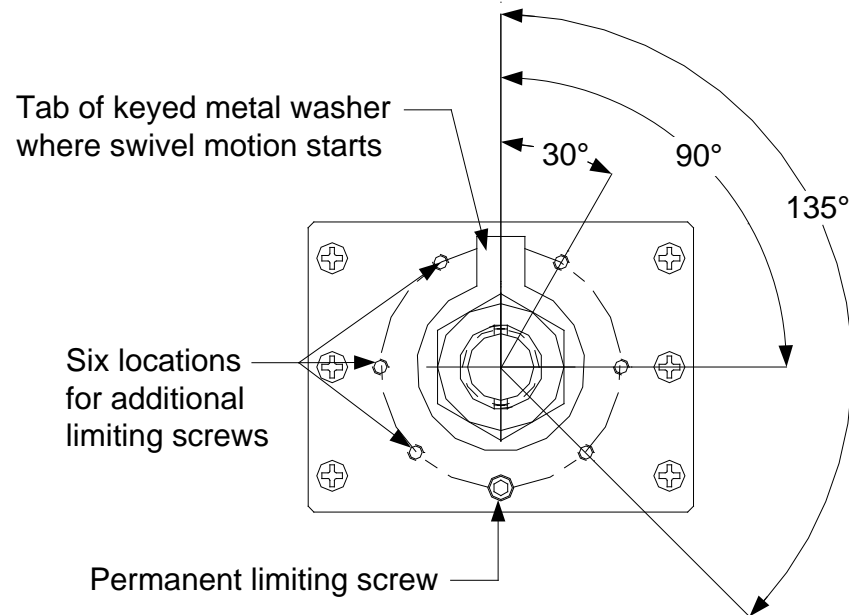

#### ***Swivel Stop Plate with Additional Limiting Screws***

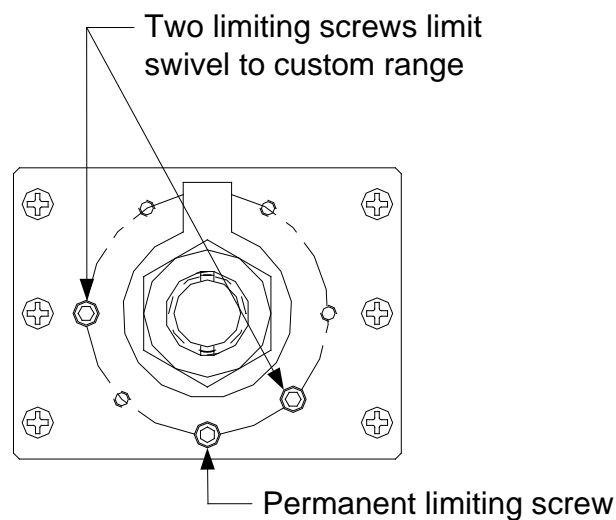

## Resources

### Further Inquiries

To locate specific information or resolve questions after reviewing this guide, contact Crestron's True Blue Support at 1-888-CRESTRON [1-888-273-7876] or, for assistance within a particular geographic region, refer to the listing of Crestron worldwide offices at [www.crestron.com/offices](http://www.crestron.com/offices).

To post a question about Crestron products, log onto Crestron's Online Help at [www.crestron.com/onlinehelp](http://www.crestron.com/onlinehelp). First-time users must establish a user account to fully benefit from all available features.

### Future Updates

As Crestron improves functions, adds new features, and extends the capabilities of the TST-600-SMK, additional information may be made available as manual updates. These updates are solely electronic and serve as intermediary supplements prior to the release of a complete technical documentation revision.

Check the Crestron website periodically for manual update availability and its relevance. Updates are identified as an "Addendum" in the Download column.



**Crestron Electronics, Inc.**  
15 Volvo Drive Rockleigh, NJ 07647  
Tel: 888.CRESTRON  
Fax: 201.767.7576  
[www.crestron.com](http://www.crestron.com)



**Installation Guide – DOC. 7452B  
(2035126)**

**12.14**

Specifications subject to  
change without notice.