

CCS-UC-1-T

Crestron Mercury® Tabletop UC Audio Conference System for Microsoft Teams™

The CCS-UC-1-T provides a complete audio conference room solution for engineered use with the Microsoft Teams™ intelligent communications platform.

Check the Box

Item	Qty
CCS-UC-1-T	1
Cable, CAT5e, RJ-45 Male - RJ-45 Male, 12 ft (3.66 m) (P/N 2033988)	1
Retention Plate, Cable (P/N 2047908)	1
Tie Wrap (P/N 2047935)	3

Install the Cable Retention Plate

Remove the adhesive backing from the cable retention plate and install it as shown in the following diagram. The cable retention plate is designed to fit at the cable exit location at the rear of the chassis and provides three tie-down points for cables connected to the device.

CAUTION: When turning over the device, place the device on a soft surface to avoid damage.

NOTE: If the CCS-UCA-SMK swivel mount kit is to be used, use the cable retention bracket included with the CCS-UCA-SMK. For details, refer to the CCS-UCA-SMK DO Guide (Doc. 7882) at www.crestron.com/manuals.

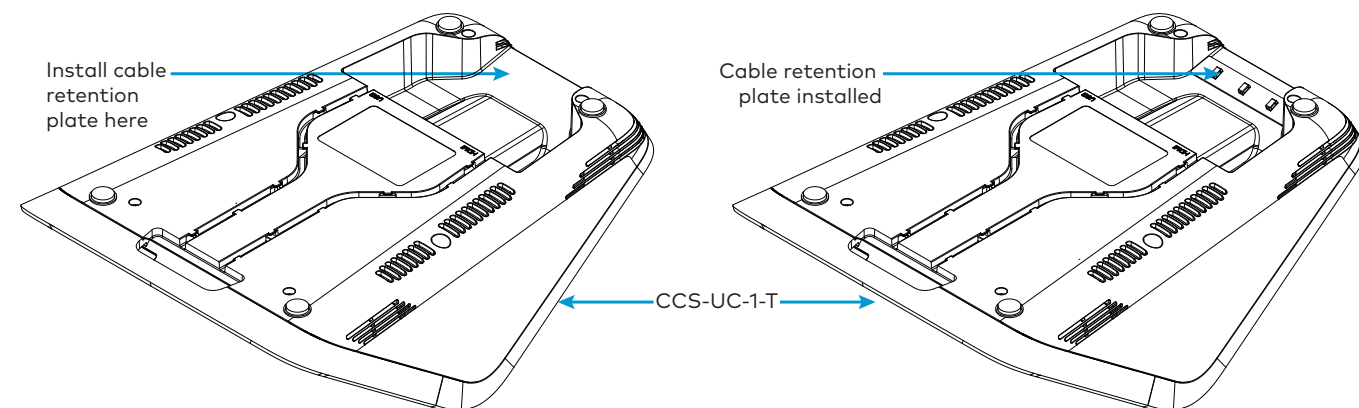

NOTE: Before securing cables, ensure the cable retention plate is firmly attached.

Connect the Device

Feed Cables Through the Swivel Tube Plate (Installations with CCS-UCA-SMK only)

If the CCS-UCA-SMK swivel mount kit is used in the installation, refer to the CCS-UCA-SMK DO Guide (Doc. 7882) for cabling instructions.

Hardware Hookup

When wiring the device, it is highly recommended to use the cables that ship with the device.

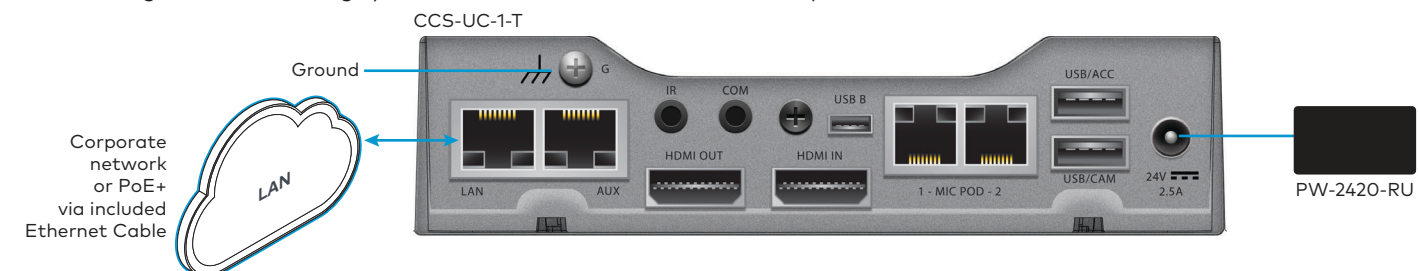

- Observe the following when making connections to the device:
 - PoE-type networks connected to these ports are for intrabuilding use only and should not be connected to lines that run outside of the building in which this device is located.
 - The device can receive power over PoE+ (IEEE 802.3at) or the PW-2420RU power pack (sold separately). A standard PoE switch cannot provide sufficient power to the device.
 - When powering the CCS-UC-1-T with PoE+ (IEEE 802.3at), PoE+ switches that utilize Link Layer Discovery Protocol (LLDP) must have LLDP enabled. Please coordinate with the IT Administrator who manages network infrastructure at the customer site to make sure the PoE+ ports have LLDP enabled. For more information, refer to the CCS-UC-1-T Supplemental Guide (Doc. 8401).
 - The PW-2420RU power pack must be connected to the CCS-UC-1-T if the optional CCS-UCA-MIC microphone pods are to be used.
- Connect the 12 ft CAT5e cable to the LAN port on the device and the local network.
- Use the provided tie wraps to secure the cables to the cable retention plate, leaving enough cable to create a 2- to 3-inch service loop.

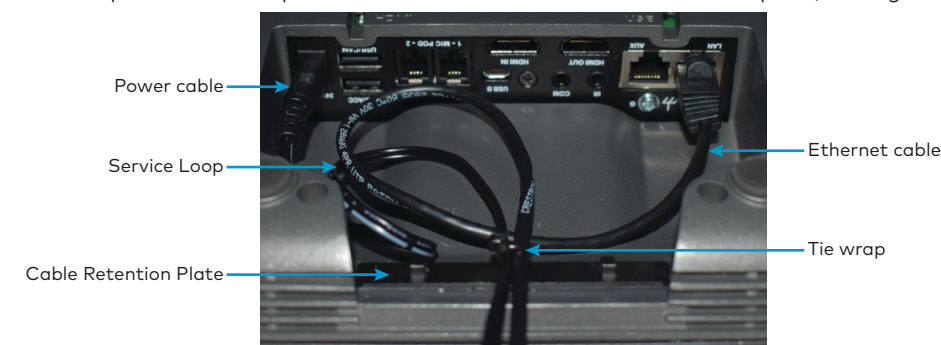

Configure the Device

Use the touch screen of the device and the web interface to configure the device. For details, refer to the CCS-UC-1-T Supplemental Guide (Doc. 8401).

NOTE: A Microsoft Teams account is required for operation.

For Additional Information

Scan or click the QR code for detailed product information.



CCS-UC-1-T



Compliance and Legal

As of the date of manufacture, the product has been tested and found to comply with specifications for CE marking.



Federal Communications Commission (FCC) Compliance Statement

This device complies with part 15 of the FCC Rules. Operation is subject to the following conditions: (1) This device may not cause harmful interference and (2) this device must accept any interference received, including interference that may cause undesired operation.

CAUTION: Changes or modifications not expressly approved by the manufacturer responsible for compliance could void the user's authority to operate the equipment.

NOTE: This equipment has been tested and found to comply with the limits for a Class B digital device, pursuant to part 15 of the FCC Rules. These limits are designed to provide reasonable protection against harmful interference in a residential installation. This equipment generates, uses and can radiate radio frequency energy and, if not installed and used in accordance with the instructions, may cause harmful interference to radio communications. However, there is no guarantee that interference will not occur in a particular installation. If this equipment does cause harmful interference to radio or television reception, which can be determined by turning the equipment off and on, the user is encouraged to try to correct the interference by one or more of the following measures:

- Reorient or relocate the receiving antenna.
- Increase the separation between the equipment and receiver.
- Connect the equipment into an outlet on a circuit different from that to which the receiver is connected.
- Consult the dealer or an experienced radio/TV technician for help.

Industry Canada (IC) Compliance Statement

CAN ICES-3 (B)/NMB-3(B)

The product warranty can be found at www.crestron.com/warranty.

The specific patents that cover Crestron products are listed at www.crestron.com/legal/patents.

Certain Crestron products contain open source software. For specific information, please visit www.crestron.com/opensource.

Crestron, the Crestron logo, and Crestron Mercury are either trademarks or registered trademarks of Crestron Electronics, Inc. in the United States and/or other countries. HDMI is either a trademark or registered trademark of HDMI Licensing LLC in the United States and/or other countries. Microsoft Teams is either a trademark or registered trademark of Microsoft Corporation in the United States and/or other countries. Other trademarks, registered trademarks, and trade names may be used in this document to refer to either the entities claiming the marks and names or their products. Crestron disclaims any proprietary interest in the marks and names of others. Crestron is not responsible for errors in typography or photography.

©2018 Crestron Electronics, Inc.

Crestron Electronics, Inc.
15 Volvo Drive, Rockleigh, NJ 07647
Tel: 888.CRESTRON
Fax: 201.767.7576
www.crestron.com

**Quick Start - Doc. 8399A
(2052774)**

11.18

Specifications subject to
change without notice.