

# Crestron **BB-1000** Back Box

---

## Installation Guide



# Contents

<b>Back Box: BB-1000</b>	<b>1</b>
Description .....	1
Installation.....	2
Further Inquiries.....	4
Return and Warranty Policies .....	5
Merchandise Returns / Repair Service .....	5
CRESTRON Limited Warranty .....	5



# Back Box: BB-1000

## Description

The back Box, BB-1000, is the optional mounting hardware that is part of the Crestron Home total control system. The BB-1000 secures a Crestron Series 1000 Touchpanel to a wall. The mounting hardware consists of :

- 1 - metal electrical box with 4 punches.
- 1 – stud mounting bracket.
- 1 – wall mounting bracket.
- 8 – 6-32 x 3/8” socket head screws.
- 4 – 4-40 x 3/4” pan head screws.
- 1 – template.

Three views and dimensions for the metal pieces of the BB-1000 are shown below.

*BB-1000 Physical Views and Dimensions*

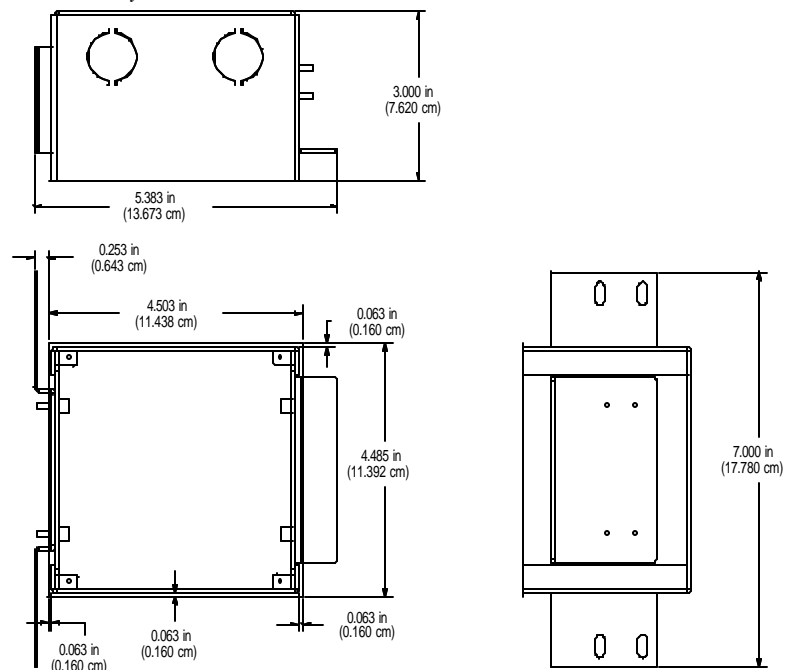

## Installation

Complete the following installation procedure in the order provided. The only tools required are a drywall saw ( or equivalent) and socket screwdriver.

1. Locate an area on the wall that is ¼” (0.635 cm) from either side of a stud.
2. Fasten the supplied template to the wall; verify that the cutout is level.
3. Cut out the rectangular area illustrated on the template.
4. Remove the template and rectangular drywall cutout.
5. Use template and rectangular drywall cutout and place mounting bracket alignment marks on wall, as shown below.

*Mounting Bracket Alignment Marks*

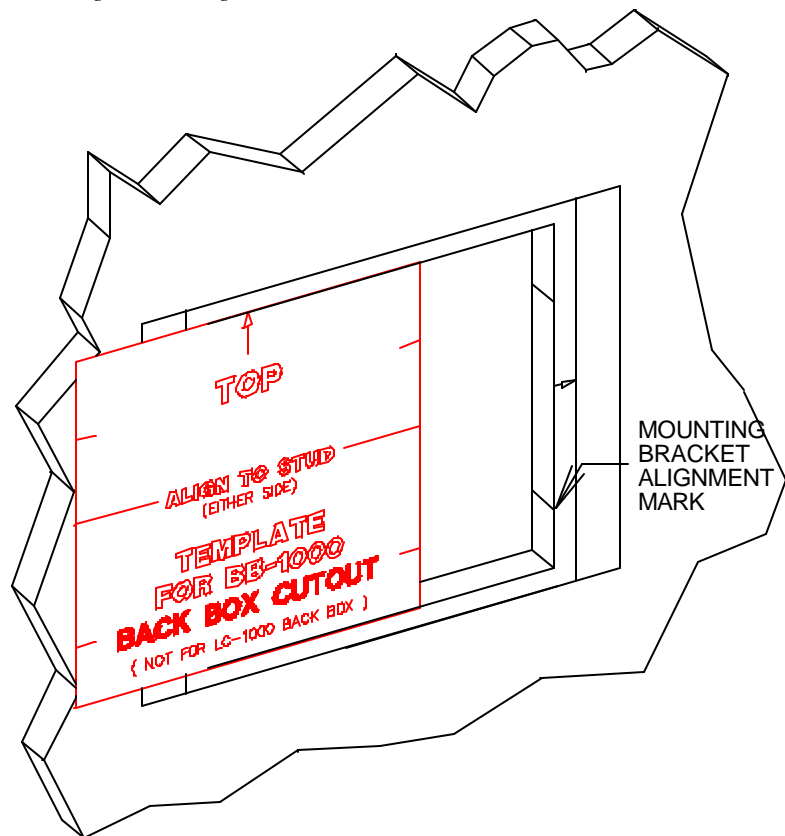

6. Position stud mounting bracket to front edge of stud (closest to drywall) and align corners of the raised part of the bracket with the mounting bracket alignment marks on the wall. Refer to the illustration on the next page.

*Aligning Mounting Bracket Alignment Mark with Corner of Stud Bracket*

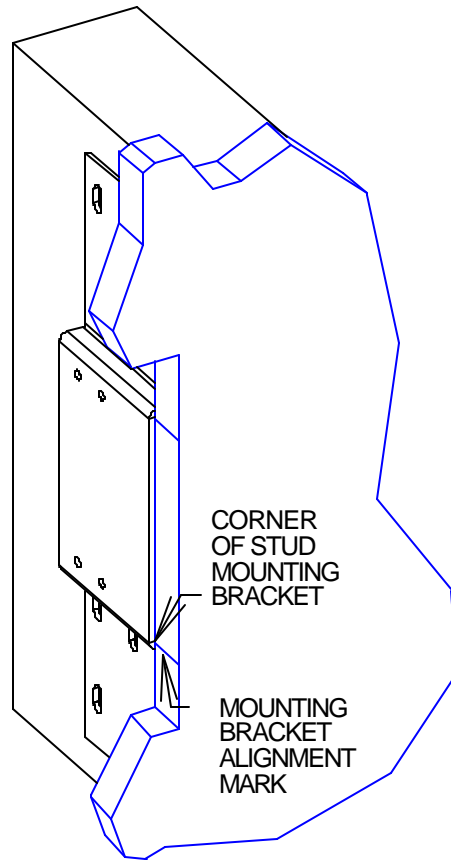

7. Using four screws, not supplied, secure stud mounting bracket to stud, as shown below.

*Secure Stud Mounting Bracket*

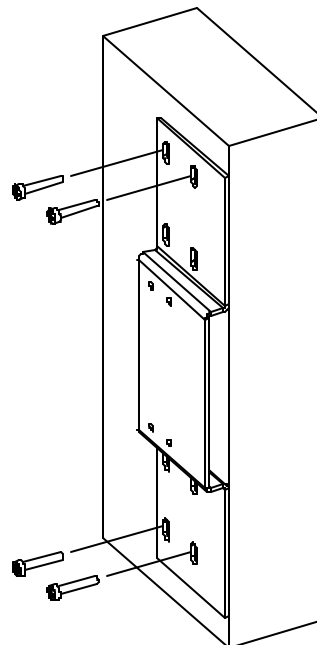

8. Use four socket head screws, supplied, to attach wall mounting bracket to electrical box, as shown below.

*Attach Wall Mounting Bracket to Electrical Box*

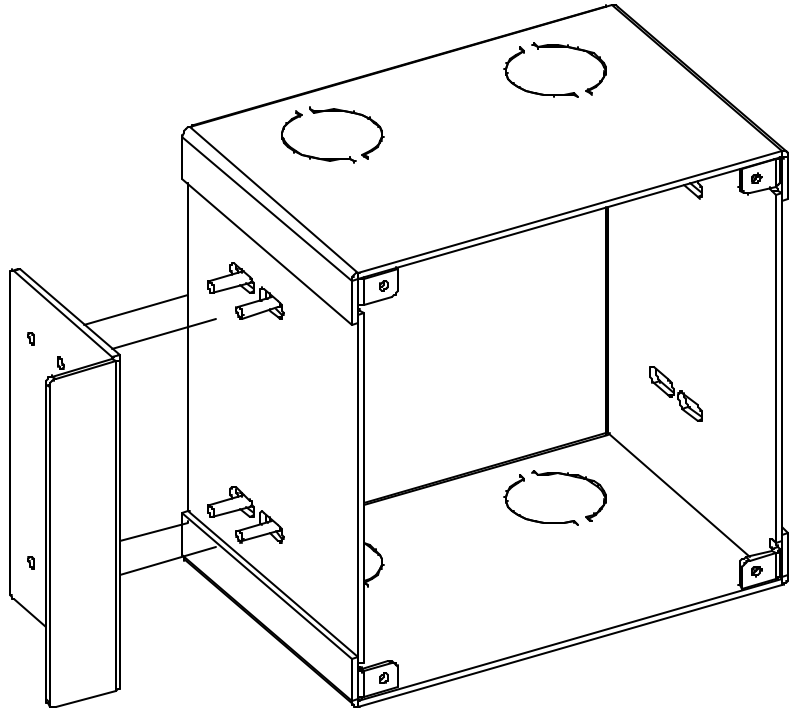

9. Position bracket-electrical box assembly into wall opening and secure to stud mounting bracket with four socket head screws, supplied.
10. If touchpanel is available, secure touchpanel to BB-1000 using four pan head screws, supplied. If touchpanel is not available, insert screws into holes for future use.

---

## Further Inquiries

If after reviewing this Installation Guide for the BB-1000, you cannot locate specific information or have questions, please take advantage of Crestron's award winning technical support team by calling:

- In the US and Canada, call Crestron's corporate headquarters at 1-888-CRESTRON [1-888-273-7876] or 1-201-767-3400.
- In Europe, call Crestron International at +32-15-50-99-50.
- In Asia, call Crestron Asia at +852-2341-2016.
- In Latin America, call Crestron Latin America at +525-574-15-90.

For local support from exclusive Crestron factory-trained personnel call:

- In Australia, call Soundcorp at +613-9488-1555.
- In New Zealand, call Amber Technologies at +649-410-8382.



---

## Return and Warranty Policies

### Merchandise Returns / Repair Service

1. No merchandise may be returned for credit, exchange, or service without prior authorization from CRESTRON. To obtain warranty service for CRESTRON products, contact the factory and request an RMA (Return Merchandise Authorization) number. Enclose a note specifying the nature of the problem, name and phone number of contact person, RMA number, and return address.
2. Products may be returned for credit, exchange, or service with a CRESTRON Return Merchandise Authorization (RMA) number. Authorized returns must be shipped freight prepaid to CRESTRON, Cresskill, N.J., or its authorized subsidiaries, with RMA number clearly marked on the outside of all cartons. Shipments arriving freight collect or without an RMA number shall be subject to refusal. CRESTRON reserves the right in its sole and absolute discretion to charge a 15% restocking fee, plus shipping costs, on any products returned with an RMA.
3. Return freight charges following repair of items under warranty shall be paid by CRESTRON, shipping by standard ground carrier. In the event repairs are found to be non-warranty, return freight costs shall be paid by the purchaser.

### CRESTRON Limited Warranty

CRESTRON ELECTRONICS, Inc. warrants its Cresnet products, denoted by a "CN" prefix model number, to be free from manufacturing defects in materials and workmanship for a period of three (3) years from the date of shipment to purchaser. Disk drives and any other moving or rotating mechanical parts are covered for a period of one (1) year. CRESTRON warrants all its other products for a period of one year from the defects mentioned above, excluding touchscreen display components which are covered for 90 days. Incandescent lamps are completely excluded from Crestron's Limited Warranty. CRESTRON shall, at its option, repair or replace any product found defective without charge for parts or labor. Repaired or replaced equipment and parts supplied under this warranty shall be covered only by the unexpired portion of the warranty.

CRESTRON shall not be liable to honor warranty terms if the product has been used in any application other than that for which it was intended, or if it has been subjected to misuse, accidental damage, modification, or improper installation procedures. Furthermore, this warranty does not cover any product that has had the serial number altered, defaced, or removed.

This warranty shall be the sole and exclusive remedy to the purchaser. In no event shall CRESTRON be liable for incidental or consequential damages of any kind (property or economic damages inclusive) arising from the sale or use of this equipment. CRESTRON makes no other warranties nor authorizes any other party to offer any warranty, expressed or implied, including warranties of merchantability for this product. This warranty statement supersedes all previous warranties.

#### Trademark Information

*All brand names, product names, and trademarks are the sole property of their respective owners. Windows is a registered trademark of Microsoft Corporation. Windows95, Windows98 and WindowsNT are trademarks of Microsoft Corporation.*



**Crestron Electronics, Inc.**  
15 Volvo Drive Rockleigh, NJ 07647  
Tel: 888.CRESTRON  
Fax: 201.767.7576  
[www.crestron.com](http://www.crestron.com)

*Specifications  
subject to change  
without notice.*

Doc. 5814  
10.99

