

CAM-IPTZ-101

PTZ Camera for CAPTURE-HD & CAPTURE-HD-PRO



The CAM-IPTZ-101 is a Canon® PTZ camera capable of capturing high-quality video from a wide range of angles. The CAM-IPTZ-101 captures crystal clear, high-contrast images even in low light and is capable of dual streaming in both MJPEG and MPEG4 formats. When connected to Crestron's state of the art Capture HD® High-Definition Capture Recorder, the CAM-IPTZ-101 is the perfect camera for capturing various angles and views of a presentation.

NOTE: For additional information and specifications for the CAM-IPTZ-101, refer to the Crestron® Web site (www.crestron.com). Refer also to the information and materials from the manufacturer included with the camera.

A. Accessories

- Video adapter cable, BNC jack to 3.5 mm plug, 8" (203 mm) long, supplied
- Ethernet cables, available separately
- BNC video interface cable, available separately

B. Camera Configuration Settings

The CAM-IPTZ-101 comes from the factory with the following settings:

- IP Address: 192.168.100.1 (static)
- User name: root
- Password: VB-C300

To configure the camera, do the following:

CAUTION: Never touch the camera head while its position is being initialized.

NOTE: The camera head position is automatically initialized when power is applied.

1. Connect the camera to a PC and LAN via a PoE hub as shown in the diagram to the right.
2. Set the PC's IP address to 192.168.100.10
3. Use the PC's Web browser to connect to <http://192.168.100.1>. When the initial screen appears, click on **Settings**.
4. When prompted, enter the user name and password given above.
5. When the "VBC300NA Settings Page" appears, click on the various setting topics and enter any necessary information.

Configuration Connections

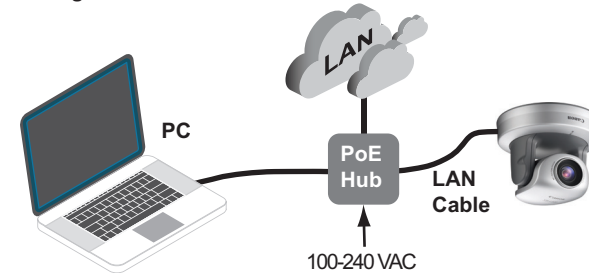

Initial Screen



"VB-C300NA Settings Page"

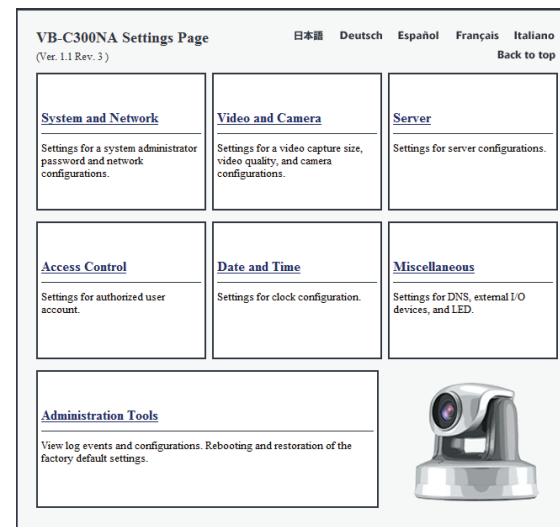

CAM-IPTZ-101

PTZ Camera for CAPTURE-HD & CAPTURE-HD-PRO

C. Hookup

Connect the camera to the CAPTURE-HD or CAPTURE-HD-PRO (not shown) as illustrated to the right.

D. Installation in Capture System

Install the camera as described in "Installer Mode" in the "Operation" section of the latest version of the CAPTURE-HD & CAPTURE-HD-PRO Operations Guide, Doc. 7233. The manual is available from the Crestron Web site at www.crestron.com/manuals.

If the installation includes the CAPTURE-TPMC-4SM touch screen controller, refer also to the "Configuration" section of the latest version of the CAPTURE-TPMC-4SM Operations Guide, Doc. 7293. To operate with the CAM-IPTZ-101 camera, the touch screen controller may require a firmware update. Use the following link to access online help Answer ID 5165: http://support.crestron.com/app/answers/detail/a_id/5165/kw/5165.

To convert a regular TPMC-4SM to a CAPTURE-TPMC-4SM, contact Crestron's True Blue Support at 1-888-CRESTRON [1-888-273-7876] or refer to the listing of Crestron worldwide offices on the Crestron Web site (www.crestron.com/offices) for assistance within a particular geographic region.

NOTE: It is recommended that the video adapter cable be secured to the camera mounting hardware to prevent accidental disconnection.

CAPTURE-HD Camera Hookup

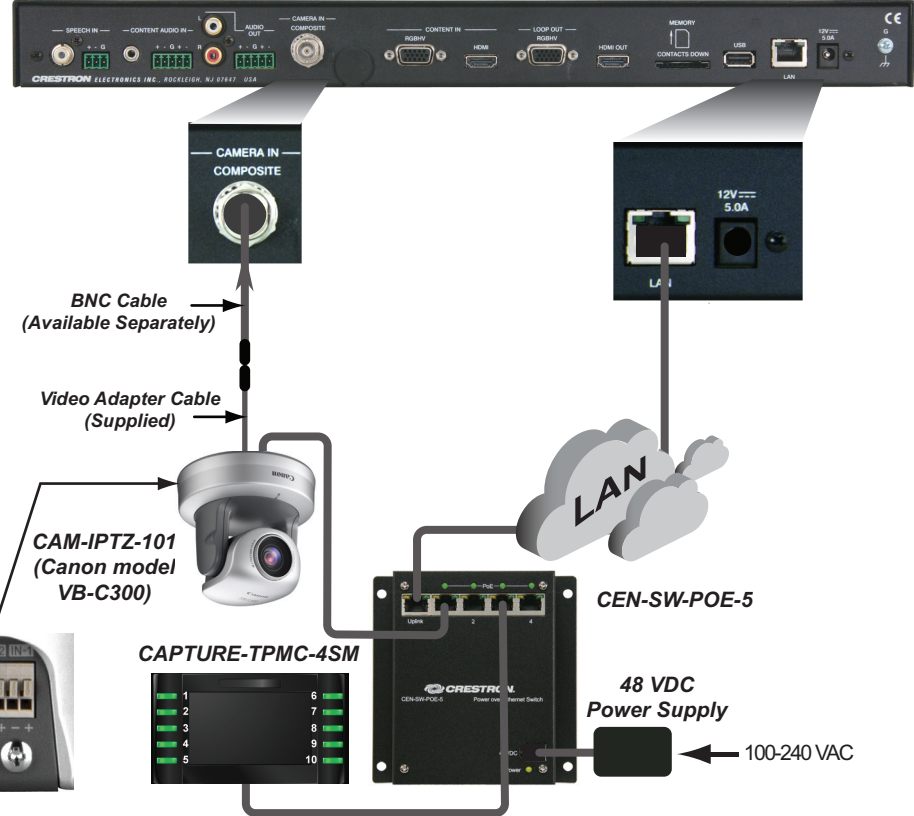

Camera Rear Panel

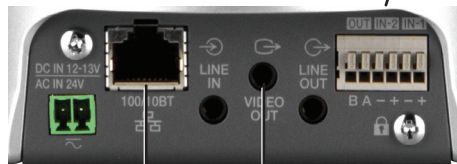

10/100 Base T Ethernet to PoE LAN
Analog Composite Video Output

The specific patents that cover Crestron products are listed at patents.crestron.com

Crestron, the Crestron logo, and Capture HD are either trademarks or registered trademarks of Crestron Electronics, Inc. in the United States and/or other countries. Canon is either a trademark or registered trademark of Canon Inc. in the United States and/or other countries. Other trademarks, registered trademarks and trade names may be used in this document to refer to either the entities claiming the marks and names or their products. Crestron disclaims proprietary interest in the marks and names of others. © 2012 Crestron Electronics, Inc.