

Shade Measuring Worksheet

Single Roller and In-Line Coupled Shades

Date: _____

Project: _____

Name: _____

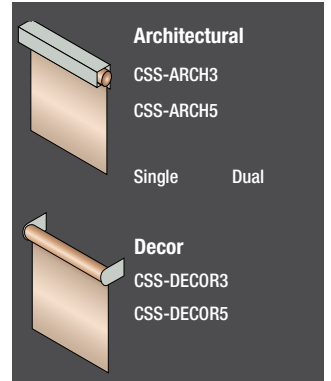
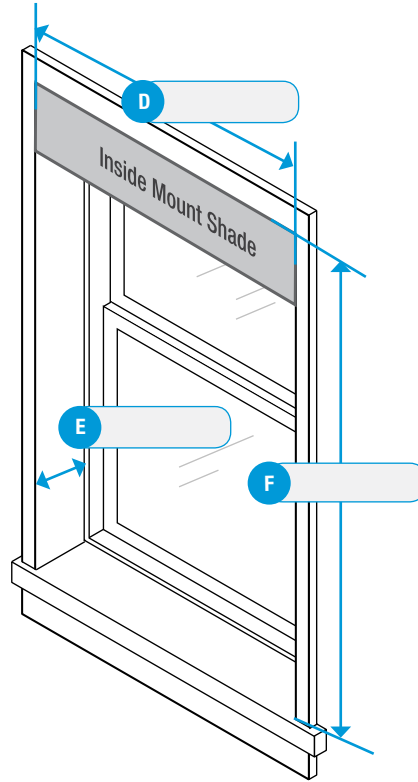
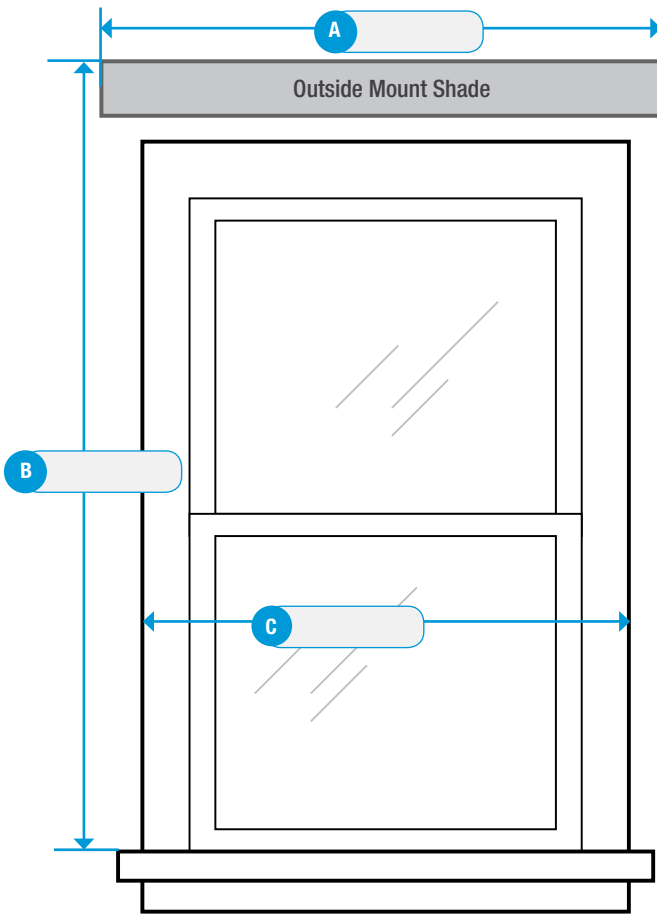

- A Outside Mount B2B
- B Shade Height
- C Total Width
- D Inside Mount B2B
- E Jamb Depth
- F Inner Height

NOTE: For the inside mount (B2B) dimension, measure across the top, center, and bottom of the window, and then enter the smallest dimension. For the inner height dimension, measure the left, center, and right window height, and then enter the smallest value.

Sketch the room or window for obstructions and other details.

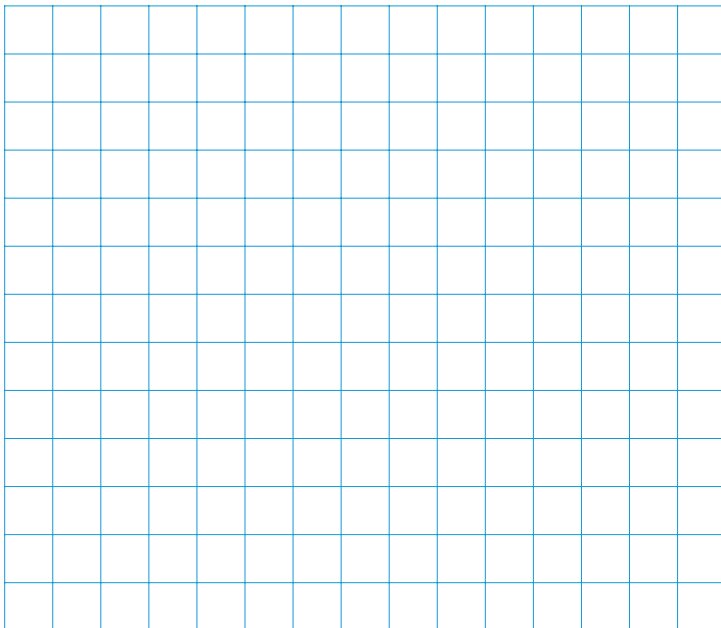

INSTRUCTIONS:

- Inspect the window and the area around the window for obstructions sticking out (knobs, sills, etc.) that may prevent the smooth travel of the shade.
- Verify the frame, sill, and header are level, and then measure all designations.
- Check the appropriate check boxes and enter the measurements.
- For in-line coupled shades use a new sheet for each band. Be sure to indicate the band location below.
- Use additional sheets as needed.

Building: _____ Floor: _____

Room: _____ Window/Door: _____

Shade Purpose: Transparent Translucent Room Darkening

Fabric #: _____

Roll Direction: Regular Reverse

Drive/Clutch: Right Left

Fascia: None Round Square

Top & Back Cover: Yes No

Color (Arch/Decor): White Gray Almond Brown Black

Color (Decor only): Bright Chrome Brushed Nickel Antique Bronze

Blackout: Side Channel Sill Angle

Drive Type: Manual Clutch Motorized

Communication: Cresnet® Control Network infiNET EX® Wireless Gateway

In-Line Coupled Shade: Band _____ of _____ (sketch required)

Notes: _____

Crestron, the Crestron logo, Cresnet, and infiNET EX are either trademarks or registered trademarks of Crestron Electronics, Inc. in the United States and/or other countries. Other trademarks, registered trademarks, and trade names may be used in this document to refer to either the entities claiming the marks and names or their products. Crestron disclaims any proprietary interest in the marks and names of others. Crestron is not responsible for errors in typography or photography.
 ©2016 Crestron Electronics, Inc. Doc. 7925A (2047204) 08.16