

CBL-MULTI-HD-6

Multihead Cable

Installation Guide



Introduction

The Crestron® CBL-MULTI-HD-6 multihead cable is a directional cable that automatically detects and converts input signals from HDMI®, DisplayPort™, Mini DisplayPort, and USB Type-C™ sources to HDMI signals at 1080p/60 Hz resolution for use with the CCS-UC-1 Tabletop Conference System.

The cable consists of the multihead connector to connect to laptops and other sources, and a six-foot cable that splits into two short leads with USB and HDMI connectors that connect to the Crestron Mercury™ Tabletop Conference System.

Additional Resources

Visit the product page on the Crestron website (www.crestron.com) for additional information and the latest firmware updates. Use a QR reader application on your mobile device to scan the QR image.



Installation

This cable is directional. Place the multihead on a table so that users can connect to sources (laptops or other presentation devices). To connect the cable to the CCS-UC-1, follow this procedure:

1. Remove power from the CCS-UC-1.
2. Route the cable's HDMI and USB connectors through the underside of the CCS-UC-1, and connect them to the HDMI IN and USB/ACC ports.

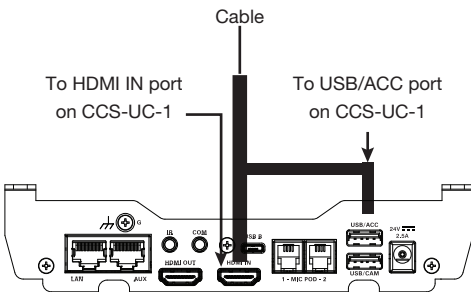

NOTE: Do not connect the HDMI connector to the HDMI OUT port on the CCS-UC-1. The cable is directional and cannot be used in that direction.

NOTE: The CBL-MULTI-HD-6 requires external power of 300 mA provided by the USB/ACC port. This power can also be supplied by a device with a USB HID port that supplies more than 300 mA, or a 2 to 10 watt USB charging device (not included).

NOTE: Do not connect the USB connector to the USB/CAM port on the CCS-UC-1.

3. Create a generous bend radius at both connections, and press the cable into the cable channel shown below.

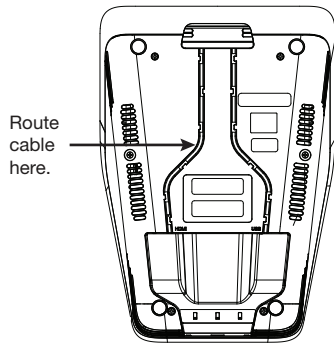
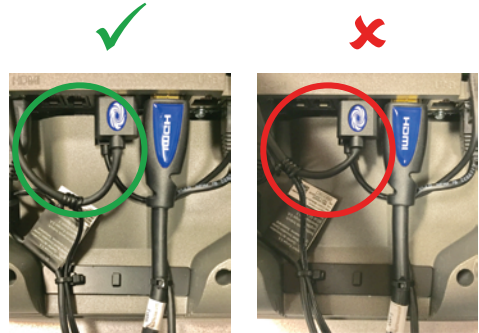

4. Apply power to the CCS-UC-1.

Operation

1. On the CCS-UC-1, select **HDMI** as the source to present.
2. Connect the source to the appropriate connector on the multihead. The source's content displays on the display device connected to the CCS-UC-1.

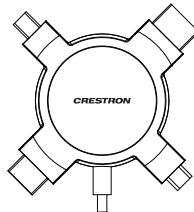

NOTE: Do not use extension cables. Using an extension for any connector results in failure and/or intermittent audio and video.

NOTE: Only one input source should be connected at a time.

NOTE: The multihead cable does not scale the video signal.

As of the date of manufacture, the product has been tested and found to comply with specifications for CE marking.



Federal Communications Commission (FCC) Compliance Statement

This device complies with part 15 of the FCC Rules. Operation is subject to the following conditions: (1) This device may not cause harmful interference and (2) this device must accept any interference received, including interference that may cause undesired operation.

CAUTION: Changes or modifications not expressly approved by the manufacturer responsible for compliance could void the user's authority to operate the equipment.

NOTE: This equipment has been tested and found to comply with the limits for a Class B digital device, pursuant to part 15 of the FCC Rules. These limits are designed to provide reasonable protection against harmful interference in a residential installation. This equipment generates, uses and can radiate radio frequency energy and, if not installed and used in accordance with the instructions, may cause harmful interference to radio communications. However, there is no guarantee that interference will not occur in a particular installation. If this equipment does cause harmful interference to radio or television reception, which can be determined by turning the equipment off and on, the user is encouraged to try to correct the interference by one or more of the following measures:

- Reorient or relocate the receiving antenna.
- Increase the separation between the equipment and receiver.
- Connect the equipment into an outlet on a circuit different from that to which the receiver is connected.
- Consult the dealer or an experienced radio/TV technician for help.

Industry Canada (IC) Compliance Statement

CAN ICES-3 (B)/NMB-3(B)

Product warranty can be found at www.crestron.com/warranty.

The specific patents that cover Crestron products are listed at patents.crestron.com.

Certain Crestron products contain open source software. For specific information, please visit www.crestron.com/opensource.

Crestron, the Crestron logo, and Crestron Mercury are either trademarks or registered trademarks of Crestron Electronics, Inc. in the United States and/or other countries. HDMI is either a trademark or registered trademark of HDMI Licensing LLC in the United States and/or other countries. USB Type-C is either a trademark or registered trademark of the USB Implementers Forum in the United States and/or other countries. DisplayPort is either a trademark or registered trademark of the Video Electronics Standards Association in the United States and/or other countries. Other trademarks, registered trademarks, and trade names may be used in this document to refer to either the entities claiming the marks and names or their products. Crestron disclaims any proprietary interest in the marks and names of others. Crestron is not responsible for errors in typography or photography.

This document was written by the Technical Publications department at Crestron.

©2017 Crestron Electronics, Inc.

Crestron Electronics, Inc.

15 Volvo Drive
Rockleigh, NJ 07647
Tel: 888.CRESTRON
Fax: 201.767.7576
www.crestron.com

Installation Guide

DOC. 7998C

(2048872)

11.17

Specifications subject to
change without notice.