



**Description**

The Crestron® Battery-Powered Wireless Keypad (ZUMMESH-KPBATT) provides control of one or more Zūm™ load controllers (not included). It is available with a rocker switch or a combination of pushbuttons. The rocker switch version offers on/off switching and dimming adjustment, with the ability to save one scene preset. The pushbutton versions support the same capabilities with additional scene presets.

The ZUMMESH-KPBATT mounts to a standard electrical box, or can be attached directly to the wall using screws or two-sided adhesive tape. A finished installation requires a decorator-style faceplate (not included).

Battery-powered Zūm keypads are designed in the following four configurations:

- Single-Rocker Switch – Simple on and off lighting control
- Four-Button Keypad – Two buttons for on and off control and two scene recall buttons
- Six-Button Keypad – Two buttons for on and off control, two buttons for dimming up and dimming down, and two scene recall buttons
- Six-Button Keypad with Sensor Control - Two buttons for on and off control, two buttons for dimming up and dimming down, one button for scene recall, and one button for disabling the sensors in the room

**Additional Resources**

Visit the product page on the Crestron website ([www.crestron.com](http://www.crestron.com)) for additional information and the latest firmware updates. Use a QR reader application on your mobile device to scan the QR image.



**Zūm Overview**

A Zūm space consists of one space, such as a board room or conference room, that is equipped with Zūm mesh devices (i.e., dimmers, switches, keypads, and sensors) in the space provide control and communicate directly with each other without the need for a centralized gateway or processor.

To expand the functionality of the Zūm space, a ZUMMESH-NETBRIDGE (not included) can be added which provides centralized control and monitoring from a Crestron control system (not included).

**NOTE:** The ZUMMESH-NETBRIDGE requires a compatible J-box device (not included) to provide power.

**Installation**

Mount the ZUMMESH-KPBATT to a single-gang box or directly to a flat surface using double-sided tape.

**NOTE:** Observe the following points.

- Codes: Install in accordance with all local and national electrical codes.
- Temperature: For use where temperatures are between 32° to 104 °F (0° to 40 °C).
- Electrical Boxes: Several devices can be installed in one electrical box (multigang). For a smooth appearance, install one-piece multigang faceplates (not included).

**Single-Gang Box Mounting**

Secure the ZUMMESH-KPBATT to a single-gang box using the two supplied screws. Attach a decorator-style faceplate (not included).

Two screws are supplied for mounting the keypad to a back box.

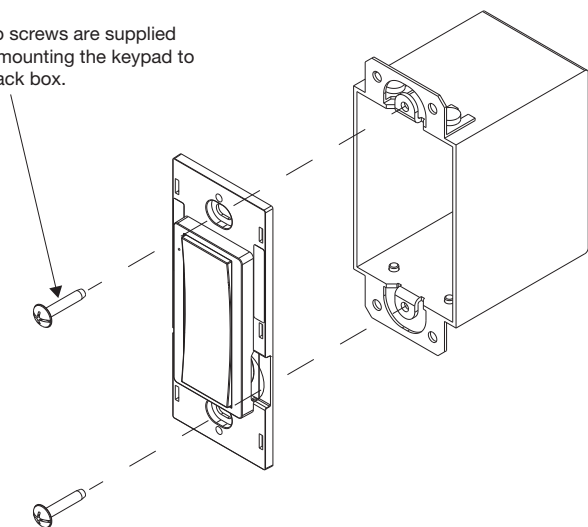

**Double-Sided Tape Mounting**

Secure the ZUMMESH-KPBATT to a flat, clean surface using the supplied double-sided tape.

1. Clean the mounting surface with a light cleaning agent that does not leave a residue.
2. Remove the backing of one piece of the double-sided tape and apply it to the back of the keypad. Repeat for the other piece of double-sided tape.

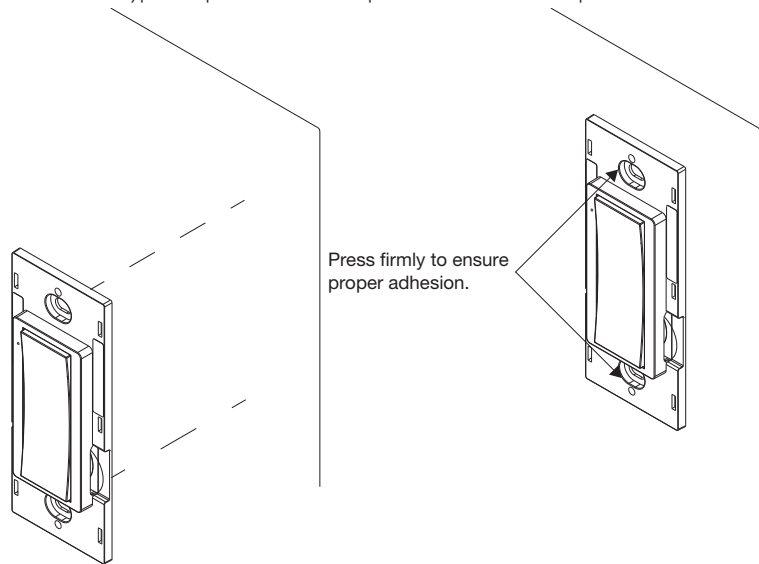

3. Ensure that the keypad is vertical, and press it against the wall. Press firmly to ensure that the keypad is properly secured to the wall.

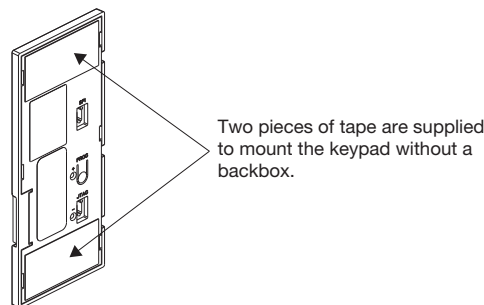

**Battery**

Prior to operation, remove the battery tab to turn on the keypad.

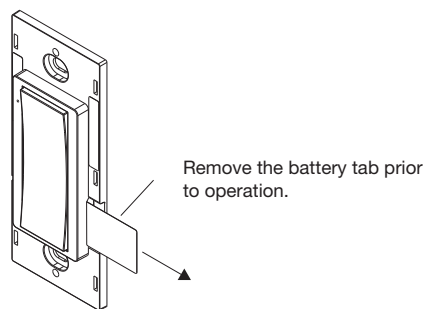

**Battery Replacement**

To remove the battery, insert a pin or paper clip into the slot on the left side of the keypad. The battery slides out of the opposite side of the keypad.

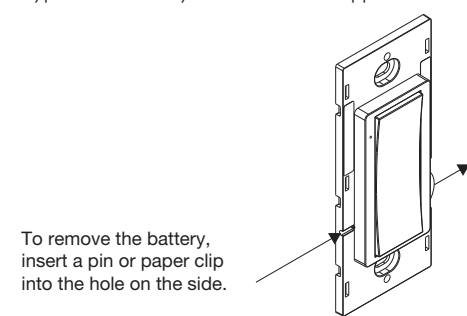

To remove the battery, insert a pin or paper clip into the hole on the side.

- NOTE:** The battery must be inserted properly.  
**NOTE:** The keypad will not operate if the battery is inserted incorrectly.

To install a new battery, insert the battery into the battery slot. The — terminal faces away from the wall.

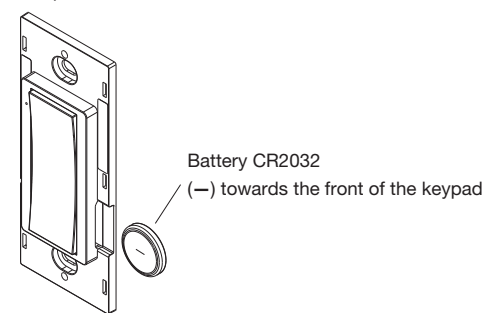

**Default Button Functions**

Crestron offers several ZUMMESH-KPBATT units. The ZUMMESH-KPBATT's functionality is based upon its button layout. By default, they control all loads in the room. If linked to a dimmer, the ZUMMESH-KPBATT controls only its linked loads.

**ZUMMESH-KP10ABATT Button Functions**

- Top Button  
Press: Recalls Scene 1  
Hold: Raises lights
- Bottom Button  
Press: Turns lights off  
Hold: Lowers lights

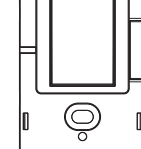

**ZUMMESH-KP10BBATT Button Functions**

- On  
Press: Recalls Scene 1  
Hold: Raises lights
- SCENE 2  
Press: Recalls Scene 2  
Hold 5 Seconds: Saves Scene 2
- SCENE 3  
Press: Recalls Scene 3  
Hold 5 Seconds: Saves Scene 3
- OFF  
Press: Turns lights off  
Hold: Lowers lights

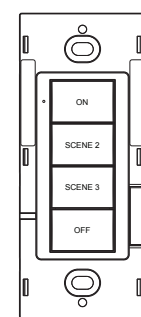

**ZUMMESH-KP10CBATT Button Functions**

- On  
Press: Recalls Scene 1  
Hold: No action
- SCENE 2  
Press: Recalls Scene 2  
Hold 5 Seconds: Saves Scene 2
- SCENE 3  
Press: Recalls Scene 3  
Hold 5 Seconds: Saves Scene 3
- OFF  
Press: Turns lights off
- ▲  
Hold: Raises lights
- ▼  
Hold: Lowers lights

**ZUMMESH-KP10DBATT Button Functions**

- On  
Press: Recalls Scene 1  
Hold: No action
- SCENE 2  
Press: Recalls Scene 2  
Hold 5 Seconds: Saves Scene 2
- SENSOR DISABLE  
Press: Recalls Scene 3  
Hold 5 Seconds: Saves Scene 3
- OFF  
Press: Turns lights off
- ▲  
Hold: Raises lights
- ▼  
Hold: Lowers lights

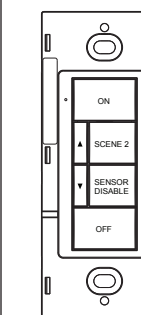

**How to Set Up a Zūm Space and Add Zūm Devices**

Once all devices are physically installed in a board room or conference space, a new Zūm space can be created and devices added.

**NOTE:** Only set up one Zūm space at a time.

**NOTE:** For simplified setup of a Zūm space, use the Zūm app on a mobile device.

**Step 1 Create a New Zūm Space**

Creating a Zūm space defines the area where the devices are located, such as a board room or conference room. A Zūm space is created with a keypad, dimmer or switch, a J-box device, or an AV Bridge.

**NOTE:** Creating a Zūm space can only be performed by one device in the space.

**NOTE:** A Zūm space cannot be created from a battery-powered keypad.

**To create a new Zūm space using a keypad, dimmer, or switch:**

1. Press the bottom button 5 times.
2. Press and hold the bottom button until the LED on the device lights (about 10 seconds). After approximately 3 seconds, the device LED begins slowly flashing. This indicates that the Zūm space is now created and in Joining mode, allowing you to add devices.

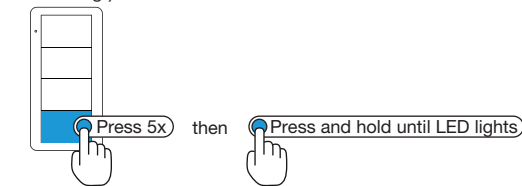

### To create a new Züm space using a J-box device or an AV Bridge:

1. Press the **SETUP** button 5 times.
2. Press and hold the **SETUP** button until the LED on the device lights (about 10 seconds). After approximately 3 seconds, the device LED begins slowly flashing. This indicates that the Züm space is now created and in Joining mode, allowing you to add devices.

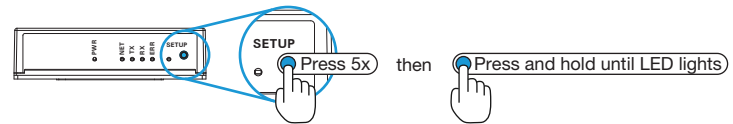
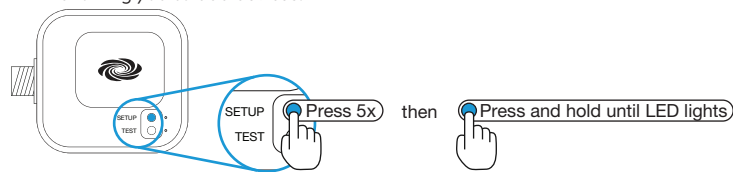

**NOTE:** The device that is used to create the Züm space is automatically added to the space and does not need to be added in Step 2.

### Step 2 Add the ZUMMESH-KPBATT to the Züm Space

After a new Züm space is created, add the ZUMMESH-KPBATT while the space is in Joining mode.

**NOTE:** A Züm mesh device can belong to only one space.

**NOTE:** Joining mode ends automatically after 4 minutes.

To add the ZUMMESH-KPBATT:

1. Press the top button 3 times.
2. Press and hold the top button until the LED on the ZUMMESH-KPBATT lights (up to 10 seconds). The LED on the ZUMMESH-KPBATT will start to flash slowly to indicate that it has joined the space.

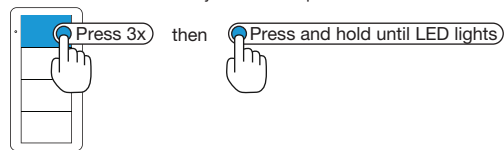

### Step 3 Complete Züm Space Setup

To finish creating a Züm space, press any button on a device that is part of the Züm space to exit Joining mode.

### Add the ZUMMESH-KPBATT to an Existing Züm Space

Add the ZUMMESH-KPBATT to an existing Züm space by placing the Züm space in Joining mode.

**Add the ZUMMESH-KPBATT using a keypad, dimmer, or switch:**

1. Enter Joining mode.
  - a. Press and hold both the top and bottom buttons until the LED lights (about 5 seconds).
  - b. Press the top button once.
  - c. Press the bottom button once. The LEDs on all devices in the space (except battery powered devices) flash slowly to indicate that the devices are part of the space and that the space is in Joining mode.

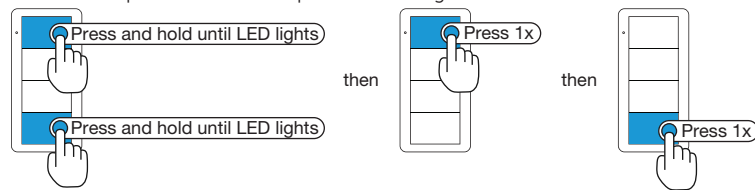

2. Add the ZUMMESH-KPBATT.
  - a. Press the top button 3 times.
  - b. Press and hold the top button until the LED on the ZUMMESH-KPBATT lights (up to 10 seconds). The LED on the ZUMMESH-KPBATT will start to flash slowly to indicate that it has joined the space.

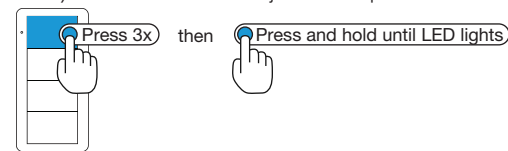

3. Press any button on a device that is part of the Züm space to exit Joining mode.

**Add the ZUMMESH-KPBATT using a J-box device:**

1. Enter Joining mode.
  - a. Press the **SETUP** button 2 times.
  - b. Press the **TEST** button once. The LEDs on all devices in the space (except battery powered devices) flash slowly to indicate that the devices are part of the space and that the space is in Joining mode.

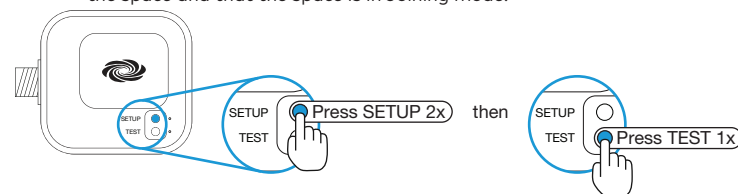

2. Add the ZUMMESH-KPBATT.
  - a. Press the top button 3 times.
  - b. Press and hold the top button until the LED on the ZUMMESH-KPBATT lights (up to 10 seconds). The LED on the ZUMMESH-KPBATT will start to flash slowly to indicate that it has joined the space.

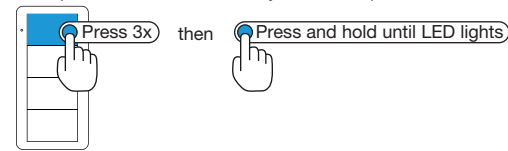

3. Press any button on a device that is part of the Züm space to exit Joining mode.

### Change the Default Scenes

The Züm keypad buttons recall predefined scenes (light levels) that are stored in the load controllers. The default scenes are ON (scene 1) which sets the loads at 90%, SCENE 2 which sets the loads at 50%, and SCENE 3 which sets the loads at 10%. Load controllers can save up to 16 scenes.

There are several methods of changing the default scenes, use the method that matches your needs.

- End-User Method - Change the light levels for SCENE 2 or SCENE 3 on a ZUMMESH-KP10ABATT when all load controllers are easily accessible.
- Manual Method - Change the light levels for ON (scene 1) on a ZUMMESH-KP10BBATT, ZUMMESH-KP10CBATT, or ZUMMESH-KP10DBATT when all load controllers are easily accessible. Additionally, SCENE 2 and SCENE 3 light levels can be changed on a ZUMMESH-KP10B.
- Remote Method - Change the light levels for ON (scene 1), SCENE 2, or SCENE 3 on a ZUMMESH-KP10ABATT, ZUMMESH-KP10BBATT, ZUMMESH-KP10CBATT, or ZUMMESH-KP10DBATT when a load controller is not physically accessible.

**NOTE:** A dimmer lowered to 0% will turn the dimmer off when the scene is recalled.

**NOTE:** A load controller that is not bound to the keypad cannot be part of the scene.

**End-User Method:**

1. Set all load controllers that are bound to the keypad to their desired light level.
2. Press and hold the **SCENE 2** or **SCENE 3** button on the keypad until the LED lights (about 5 seconds). The light levels are saved to the pressed button.

**Manual Method:**

**NOTE:** Scene 2 and Scene 3 can also be changed.

1. Enter Scene Setting Mode using the keypad that will recall the scene.
  - a. Press and hold both the top and bottom buttons until the LED lights (about 5 seconds).
  - b. Press the top button two times.
  - c. Press the bottom button once. The LED on the keypad flashes its LED two times every two seconds to indicate that it is in Scene Setting mode. Load controllers that are bound to the keypad flash their LED rapidly.

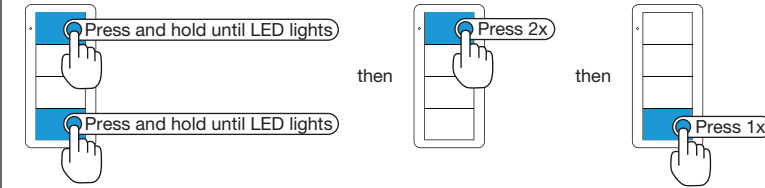

**NOTE:** Scene Setting Mode exits after 5 minutes when initiated from an ac-powered keypad or 1 minute when initiated from a battery powered keypad.

2. Adjust all light levels.
  - Using a dimmer, press and hold the top button to raise the light level or press and hold the bottom button to lower the light level.
  - Using a switch, press the top button to turn the lights on or press the bottom button to turn the lights off.
  - Using a J-box load controller, press and hold the **TEST** button on the J-box device to cycle-dim the light.
3. Using the keypad that initiated Scene Setting mode, press the **ON, SCENE 2**, or **SCENE 3** button to save the light levels to the selected scene button.
4. Repeat steps 2 and 3 for each scene button.
5. Press the bottom button on the keypad 3 times to exit.

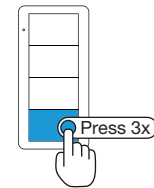

**Remote Method:**

1. Enter Scene Setting Mode using the keypad that will recall the scene.
  - a. Press and hold both the top and bottom buttons until the LED lights (about 5 seconds).
  - b. Press the top button two times.
  - c. Press the bottom button once. The LED on the keypad flashes its LED two times every two seconds. Load controllers that are bound to the keypad flash their LED rapidly.

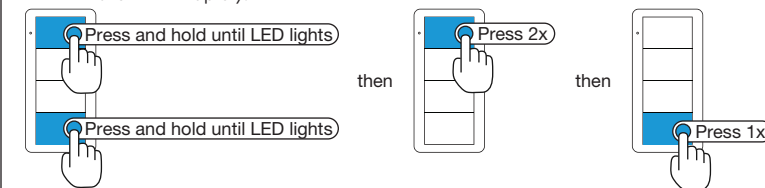

**NOTE:** Scene Setting Mode exits after 5 minutes when initiated from an ac-powered keypad or 1 minute when initiated from a battery powered keypad.

2. Press and hold the bottom button of the keypad until a set of lights in the space flashes on and off twice (about 3 seconds) to indicate that it is selected load. The lights return to their previous level.

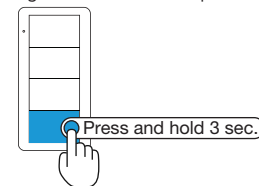

3. Press the bottom button of the keypad to cycle through all of the load controllers in the Züm space until the desired load starts flashing.

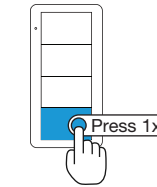

4. Adjust the light levels by holding the top button on the keypad to raise the light level or holding the bottom button on the keypad to lower the light level.
5. Press the **ON, SCENE 2**, or **SCENE 3** button to save the scene.
6. Repeat steps 3 through 5 until all load controllers and all scenes are defined.
7. Press the bottom button on the keypad 3 times to exit.

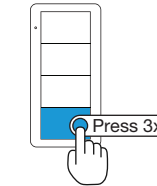

### Factory Reset

Perform a factory reset when the device is removed from the network or to remove the configuration settings. The device must also be factory reset if the device is being moved to a different system.

**NOTE:** New-in-box devices do not need to be factory reset before joining a system.

To factory reset the ZUMMESH-KPBATT:

1. Press and hold the top and bottom buttons until the LED lights (about 5 seconds).
2. Press and hold the bottom button until the LED lights (about 10 seconds).

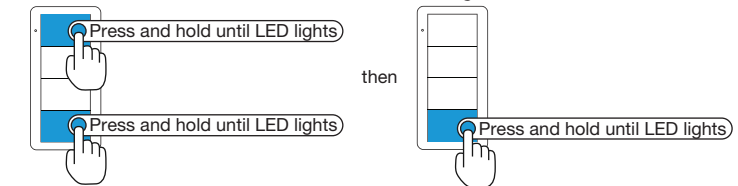

### Specifications

The specifications for the keypad are listed below.

SPECIFICATION	DETAILS
Construction	
Composition	Plastic
Surface Mounting	Adheres to a smooth, flat wall surface using double-sided tape (included) or screws (not included)
Wall Box Mounting	Mounts to a 1-gang (or larger) electrical box
Faceplate	Requires a decorator-style faceplate (sold separately)
Dimensions	
Height	4.26 in (109 mm)
Width	1.76 in (45 mm)
Depth	0.42 in (11 mm)
Power	
Battery	Battery (1) CR2032 3 Volt lithium coin cell disposable battery (included)
Battery Life	Battery Life ≥5 years
Environmental	
Temperature	32° to 104 °F (0° to 40 °C)
Humidity	10% to 90% RH (noncondensing)
Enclosure	1-gang mountable; Requires decorator-style faceplate (not included)

This product is Listed to applicable UL Standards and requirements tested by Underwriters Laboratories Inc.

Ce produit est homologué selon les normes et les exigences UL applicables par Underwriters Laboratories Inc.



#### Federal Communications Commission (FCC) Compliance Statement

This device complies with part 15 of the FCC Rules. Operation is subject to the following conditions: (1) This device may not cause harmful interference and (2) this device must accept any interference received, including interference that may cause undesired operation.

**CAUTION:** Changes or modifications not expressly approved by the manufacturer responsible for compliance could void the user's authority to operate the equipment.

**NOTE:** This equipment has been tested and found to comply with the limits for a Class B digital device, pursuant to part 15 of the FCC Rules. These limits are designed to provide reasonable protection against harmful interference in a residential installation. This equipment generates, uses and can radiate radio frequency energy and, if not installed and used in accordance with the instructions, may cause harmful interference to radio communications. However, there is no guarantee that interference will not occur in a particular installation. If this equipment does cause harmful interference to radio or television reception, which can be determined by turning the equipment off and on, the user is encouraged to try to correct the interference by one or more of the following measures:

- Reorient or relocate the receiving antenna.
- Increase the separation between the equipment and receiver.
- Connect the equipment into an outlet on a circuit different from that to which the receiver is connected.

- Consult the dealer or an experienced radio/TV technician for help.

#### Industry Canada (IC) Compliance Statement

This Class B digital apparatus complies with Canadian ICES-003.

Cet appareil numérique de la classe B est conforme à la norme NMB-003 du Canada.

The product warranty can be found at [www.crestron.com/warranty](http://www.crestron.com/warranty).

The specific patents that cover Crestron products are listed at [www.crestron.com/legal/patents](http://www.crestron.com/legal/patents).

Certain Crestron products contain open source software. For specific information, please visit [www.crestron.com/opensource](http://www.crestron.com/opensource).

Crestron, the Crestron logo, and Züm are either trademarks or registered trademarks of Crestron Electronics, Inc. in the United States and/or other countries. UL and the UL logo are

either trademarks or registered trademarks of Underwriters Laboratories, Inc. in the United States and/or other countries. Other trademarks, registered trademarks, and trade names may be used in this document to refer to either the entities claiming the marks and names or their products. Crestron disclaims any proprietary interest in the marks and names of others. Crestron is not responsible for errors in typography or photography.

This document was written by the Technical Publications department at Crestron.

©2018 Crestron Electronics, Inc.

**Crestron Electronics, Inc.**  
15 Volvo Drive, Rockleigh, NJ 07647  
Tel: 888.CRESTRON  
Fax: 201.767.7576  
[www.crestron.com](http://www.crestron.com)

**Installation Guide - DOC. 7865B**

(2047761)

05.18

Specifications subject to change without notice.