



CSS-DRAPERY

Field Modification Guide for Crestron Drapery Track Systems

Reference Guide

Crestron Electronics, Inc.

The product warranty can be found at www.crestron.com/warranty.

The specific patents that cover Crestron products are listed at patents.crestron.com.

Certain Crestron products contain open source software. For specific information, please visit www.crestron.com/opensource.

Crestron and the Crestron logo are either trademarks or registered trademarks of Crestron Electronics, Inc. in the United States and/or other countries. Other trademarks, registered trademarks, and trade names may be used in this document to refer to either the entities claiming the marks and names or their products. Crestron disclaims any proprietary interest in the marks and names of others. Crestron is not responsible for errors in typography or photography.

This document was written by the Technical Publications department at Crestron.
©2017 Crestron Electronics, Inc.

Contents

| | |
|--|-----------|
| Introduction | 1 |
| Contents | 1 |
| Recommended Tools and Hardware..... | 3 |
| Disassemble the Drapery Track | 3 |
| Modify the Drapery Track | 4 |
| Cut the Track | 4 |
| Cut the Belt..... | 4 |
| One-Way Draw Assembly | 4 |
| Split-Draw Assembly (If Applicable) | 9 |
| Assemble the Master Carrier and Arm | 15 |

CSS-DRAPERY: Field Modification Guide for Crestron Drapery Track Systems

Introduction

In certain installation scenarios it is necessary to disassemble the Crestron® drapery track, cut the track to a size appropriate for the installation, and then reassemble the track. This document details the parts and procedures necessary to modify and reassemble the track.

For information on installation of the drapery track, refer to the latest version of the CSS-DRAPERY Installation Guide (Doc. 7834), which is available from the Crestron website (www.crestron.com/manuals).

Contents

The following items are included with the drapery track to ensure proper assembly. The necessary parts are specified at the time of order and depend on the installation situation.

Track

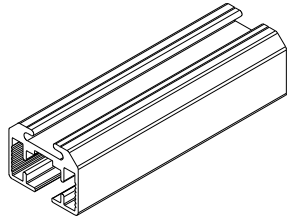

Belt

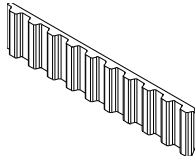

One-Way Idler Pulley

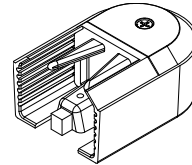

Carrier with Ripplefold Eyelet

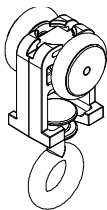

Drive Pulley

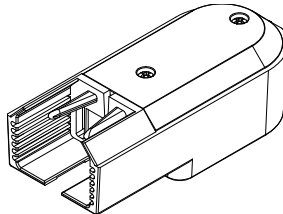

Master Carrier (Shown Disassembled)

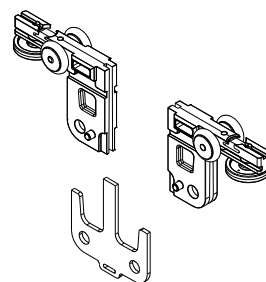

Belt Clip

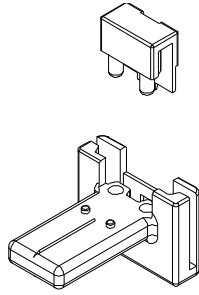

Bumper

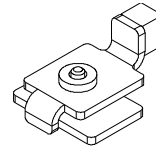

Idler, Nylon Hub, and Bracket Support

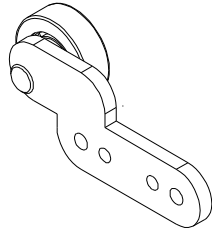

Extended Overlap Ripplefold

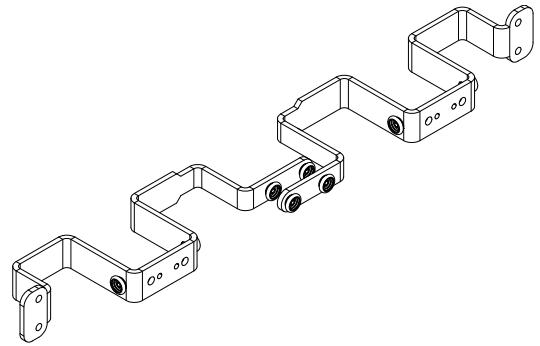

Extended Overlap Pinch Pleat

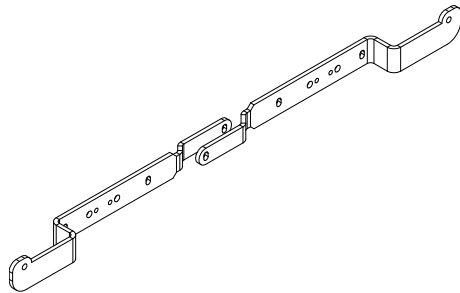

Center-Draw Butt Master

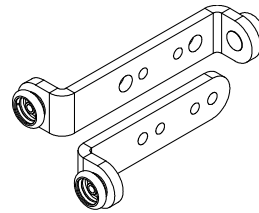

One-Way Draw Pinch Pleat

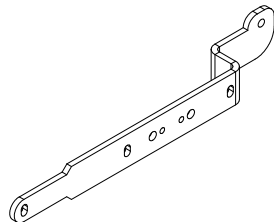

One-Way Butt Master

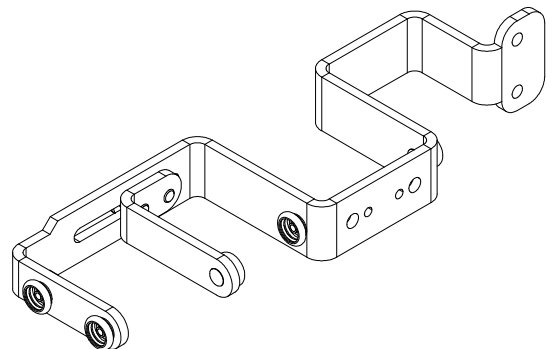

Center-Draw Overlap Pinch Pleat and Ripplefold

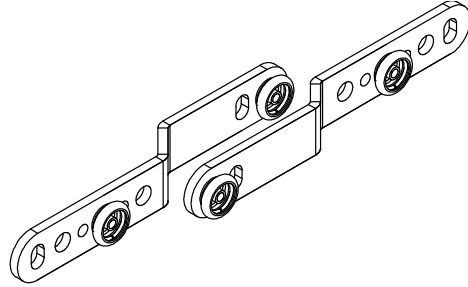

Master Carrier with Ripplefold Carriers and Cord Retainer

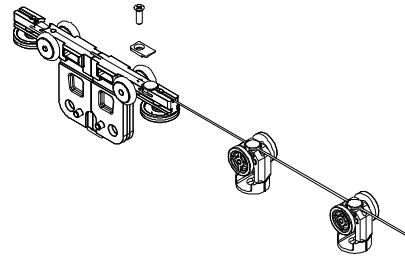

Recommended Tools and Hardware

The following tools and hardware may be necessary for installation.

- Hacksaw
- Protective glasses
- Metal File
- Phillips head screwdriver
- Scissors
- Pen
- Airblow gun
- Spring clamp

Disassemble the Drapery Track

If the drapery track is installed, first remove the drapery, then the motor, then uninstall the track and lay it on a flat surface. Refer to the Drapery Track Installation Guide (Doc. 7834) for details.

1. Remove the arm(s) from the master carrier, and then remove the joining plate. For center draw, remove the arm and joining plate from the master carrier that is closest to the drive end.
2. Remove the bumpers from the drive pulley and idler pulley of the drapery track. Retain all hardware and screws for reuse.
3. Slide and remove the carriers from the drapery track by removing them through the openings created when removing the bumpers. For ripple fold systems, the carriers are on a cord which remains attached to the master carrier.
4. Remove the drive pulley by pulling it away from the track until the end of belt with the master carrier is completely out of the track.
5. Separate the master carrier from the belt clip. Then, remove the retaining clip from the belt clip and slide the belt clip off the belt.
6. Remove the drive pulley from the belt and set aside.
7. Remove the idler pulley from the end of the track.
8. For split draw applications, remove the second master carrier from the track and repeat step 5.
9. Remove the idler pulley from the belt and set it aside.

Modify the Drapery Track

The following procedures provide instructions on cutting the drapery track to the desired length, cutting the track belt to the appropriate length, and reassembling the track.

Procedures differ for split draw drapery assembly and right or left draw drapery assembly where noted. Be sure to follow the steps appropriate for the installation.

NOTE: The drapery track must be completely disassembled and all components removed before beginning the following procedures.

Cut the Track

WARNING: Wear protective glasses to prevent injury to eyes when cutting track.

1. Measure the installation location to confirm the correct measurement where the drapery is to be installed. Then, measure and mark the required length on the track.
 - One-way Draw: Required length = measured length – 4.32 in (110 mm)
 - Center Draw: Required length = measured length – 6.03 in (153 mm)
2. Use a hacksaw to cut the track to the required length.

NOTE: If necessary, cut one end of the track so that it is square, and remove any burrs with a metal file. Then, measure the track and cut it to the required length.

3. Use a metal file to remove any burrs from the cut ends of the track.
4. Test the functionality of the track by placing the master carrier into one side of the track and sliding it along the length of the track. Repeat for other side of the track. The master carrier should slide easily through the track.

Cut the Belt

After the track has been cut to the desired length, the belt must also be shortened. Follow the procedure for “One-Way Draw Assembly” below and “Split-Draw Assembly (If Applicable)” on page 9 for assembly instructions.

One-Way Draw Assembly

NOTE: For split draw systems, cut a 4-11/32 inch (110 mm) long piece of rail that will be used as a cutting template.

1. Attach the belt clip onto the end of the belt. The teeth of the belt clip must align to the teeth on the belt.

NOTE: All teeth on the belt clip must engage with the teeth on the belt.

NOTE: Do not assemble the clasp to the belt clip at this time.

Place Belt Clip on the Belt

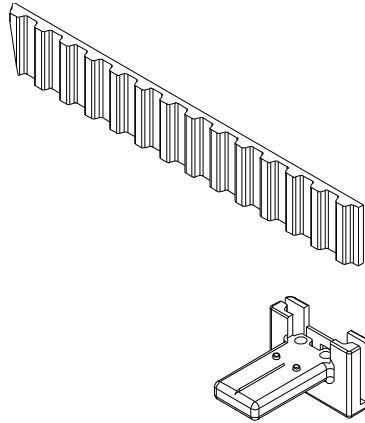

2. Place one half of the master carrier on the belt clip.

Place One-half of the Master Carrier on the Belt clip

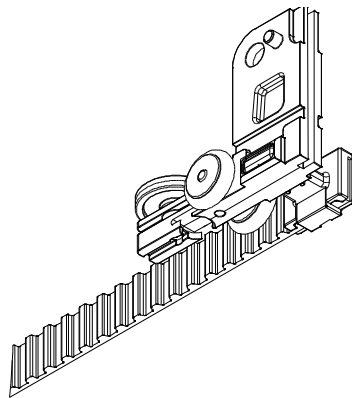

NOTE: For bent tracks, place the master carrier on the track-side with the larger radius.

3. Slide the master carrier into the track with the belt's teeth toward the center of the track. Pull it through until it exits the opposite end of the track.

Slide Master Carrier into Track

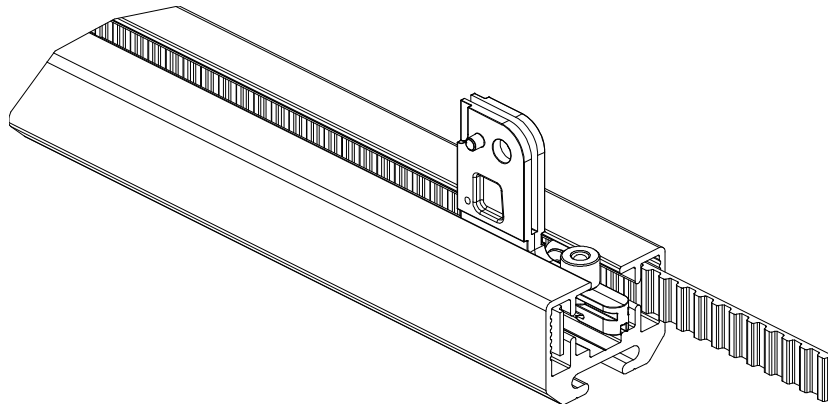

4. Remove the master carrier and the belt clip from the belt.
5. Slide the belt through the short pulley.

NOTE: When measuring the belt for one-way tracks, use the short pulley. Do not use the long pulley.

Slide the Belt Through Idler Pulley

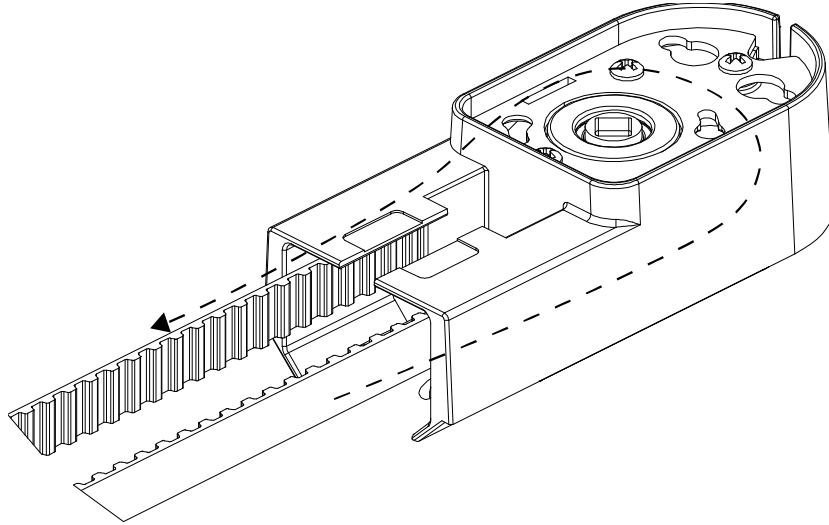

6. Replace the belt clip and master carrier onto the end of the belt as described in steps 1 and 2.

Place Master Carrier onto Belt clip

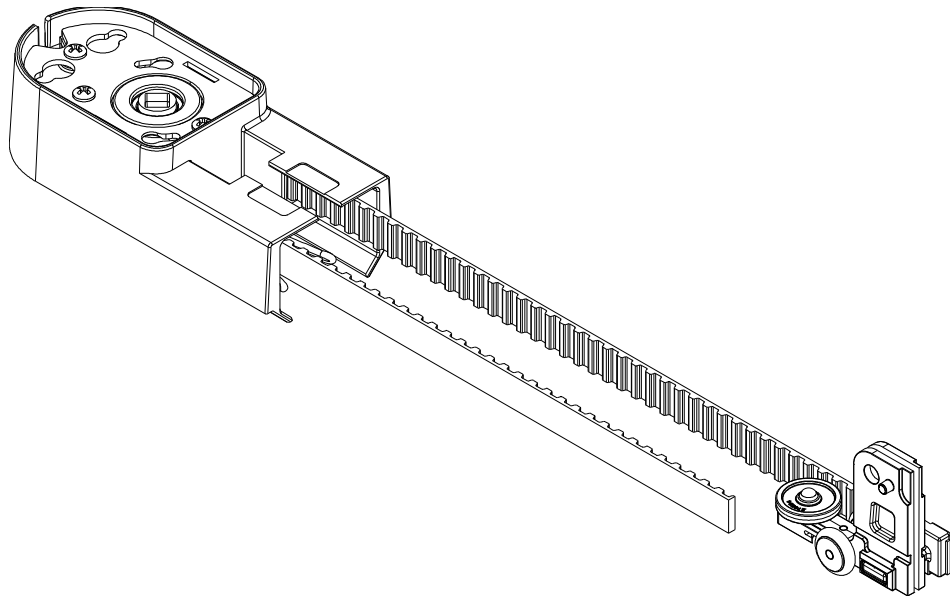

7. Slide the master carrier into the other side of the rail until the slack in the belt is removed.

Slide Master Carrier into Rail

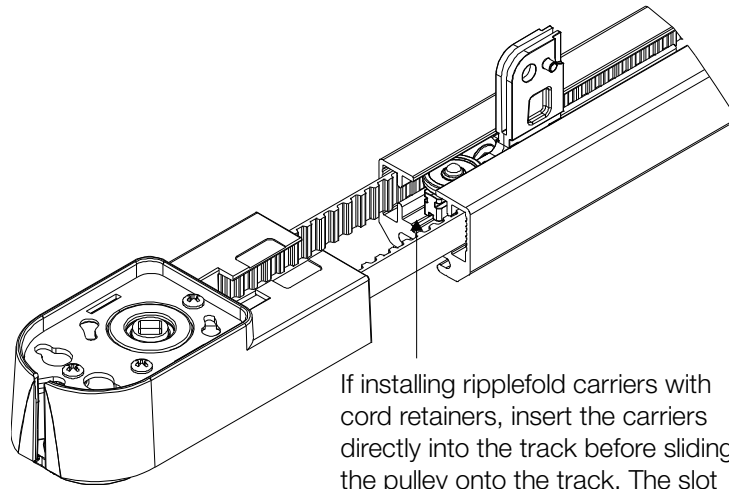

If installing ripplefold carriers with cord retainers, insert the carriers directly into the track before sliding the pulley onto the track. The slot in the carriers should face the room when the track is installed.

NOTE: If installing ripplefold carriers with cord retainers, insert the carriers directly into the track before sliding the pulley onto the track. The slot in the carriers should face the room when the track is installed.

8. Push the idler pulley onto the rail. Ensure that the belt does not get pinched and that the track is fully inserted and seated inside the pulley.

NOTE: The pulley must be fully seated onto the track before measuring the belt.

Push Idler Pulley onto Rail

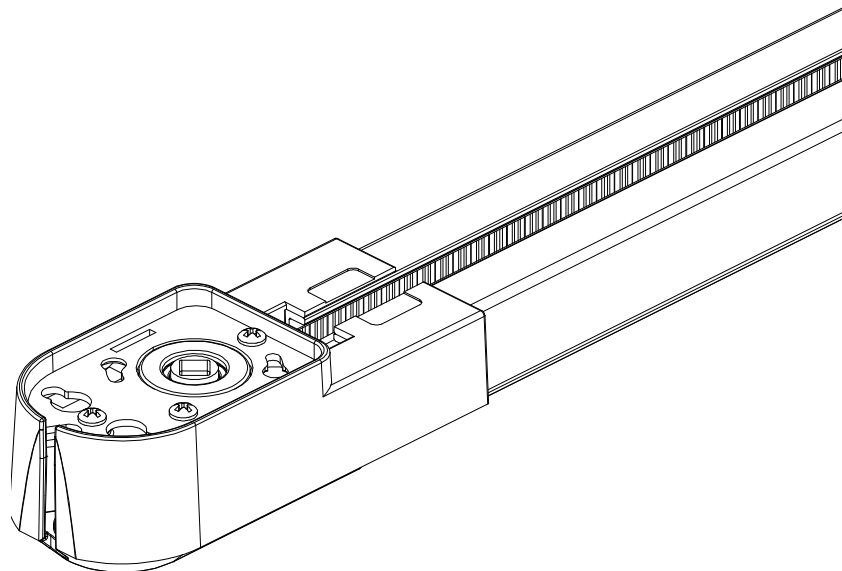

9. Slide the master carrier through the rail. Stop with the master carrier resting inside the rail at the opposite end. The master carrier should be flush with the edge of the track.
10. Place the pre-cut template at the edge of the rail.

NOTE: Make sure the master carrier remains at the end of the track and flush to the edge of the track. The master carrier should be touching the template.

NOTE: Make sure the belt stays tight and that there is no slack.

NOTE: If making a template is not possible, keep the master carrier flush with the end of the track and the template. Keep the belt tight, and count 22 teeth on the exposed belt. Then, cut the belt.

NOTE: When measuring the belt for one-way tracks, use the short pulley. Do not use the long pulley.

11. Hold the master carrier flush against the template and pull the loose end of the belt. Use scissors to cut the belt to match the length of the template. For details, refer to the illustration that follows.

Cut Belt to Template Length

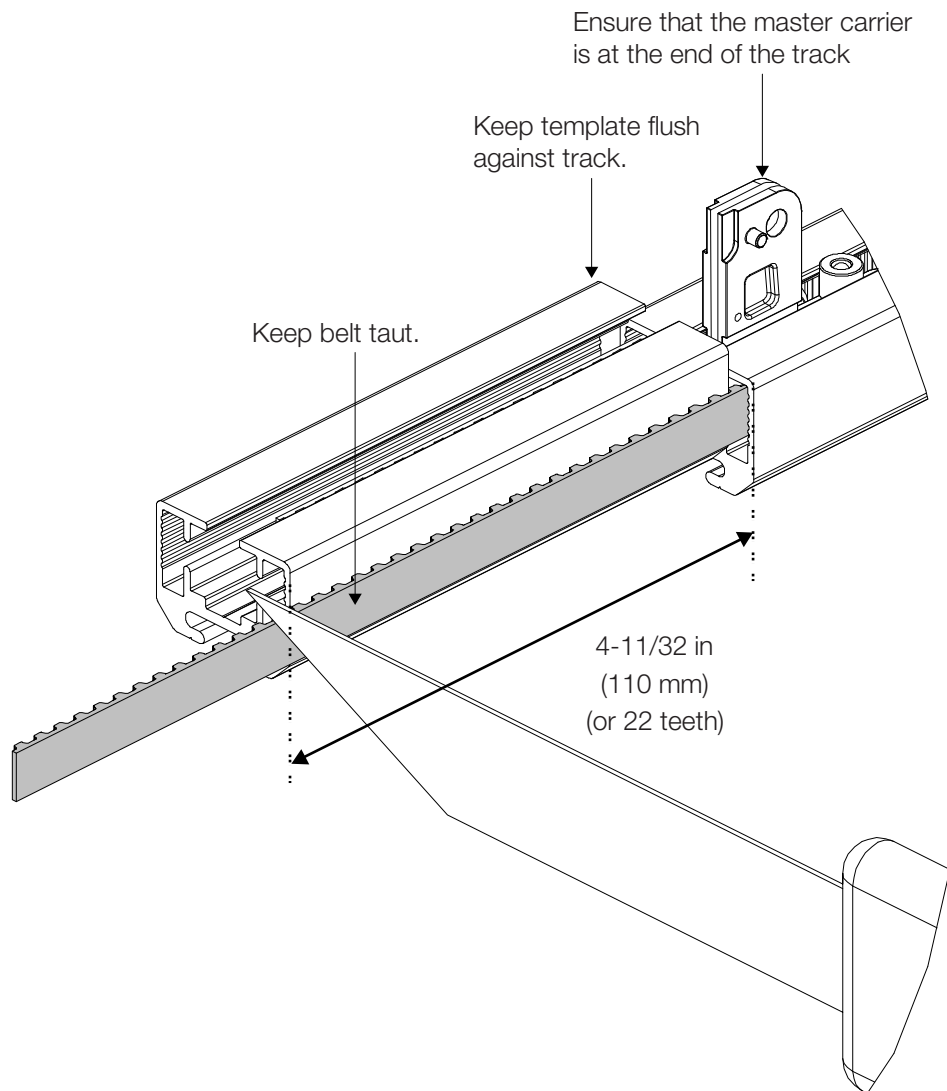

12. For split-draw applications, measure the belt and install the second master carrier. Refer to “Split-Draw Assembly (If Applicable)” on page 9 for details. Otherwise, refer

to “Assemble the Master Carrier and Arm” on page 15 to attach the arm to the master carrier.

Split-Draw Assembly (If Applicable)

Assemble the split-draw drapery track. For right or left draw assembly, refer to “Assemble the Master Carrier and Arm” on page 15.

1. Hold the loose side of the belt against the side of the template using a spring clamp. The template should be touching the rail and the master carrier should remain at the edge of the rail against the template. The end of the belt should be at the end of the template.

Hold the Belt and the Template Against the Rail

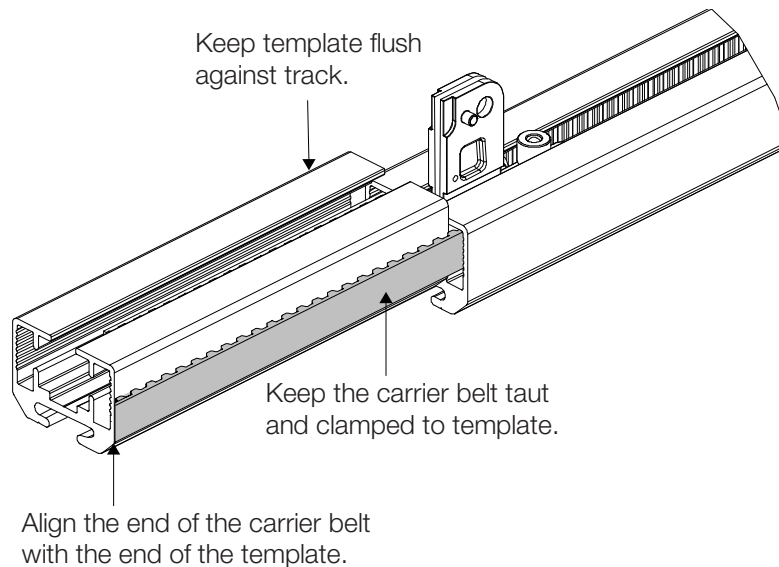

2. Remove the idler pulley 3 inches (76 mm) from the end of the track. The master carrier moves away from the other end of the template to allow the idler pulley to separate from the track. Ensure that the clamped end of the belt remains secure.
3. While making sure that the clamp is in place and the belt is taut, clearly mark the belt where it exits on the idler side of the track (on the opposite end from where it is clamped). Place the mark so that it is visible on the flat side of the belt.

Mark the Edge of the Belt

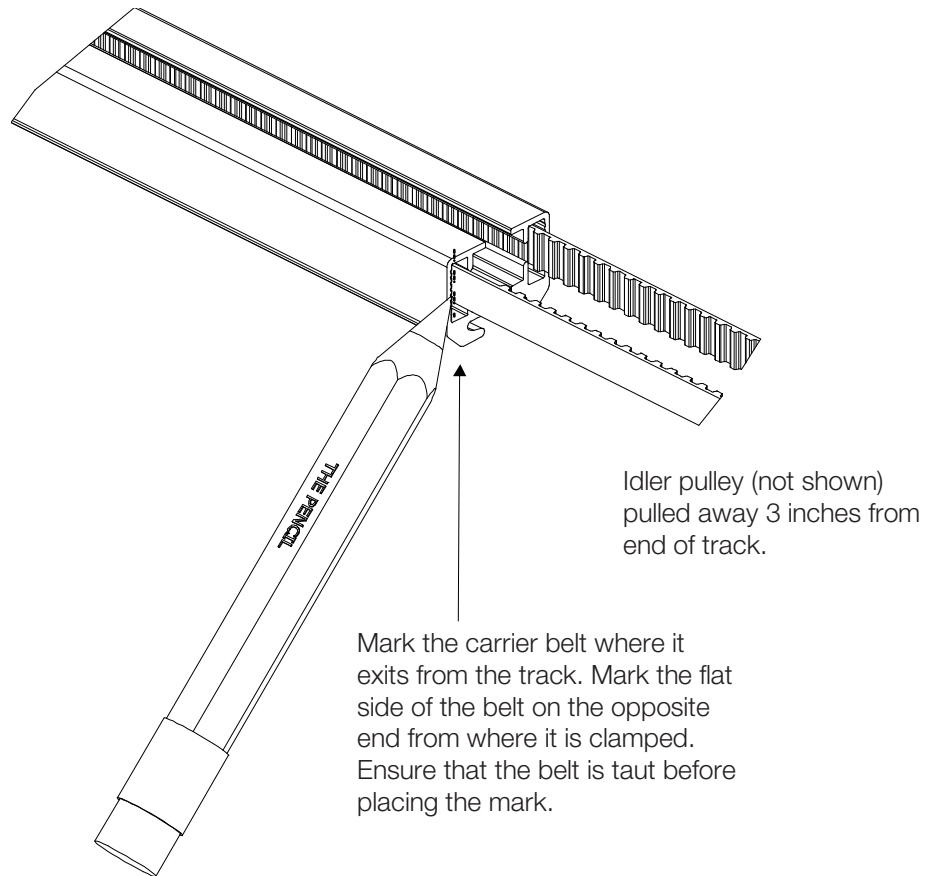

4. Release the spring clamp from the belt, then place two belt clips where the belt was marked. Pull the belt out of the track so that two belt clips can slide down onto the belt. Slide one belt clip on each side of the mark, spaced one tooth apart. Be sure to assemble the clasp onto the belt clip. Refer to the illustration in step 8 for details.

Place Belt Clips on either Side of the Mark

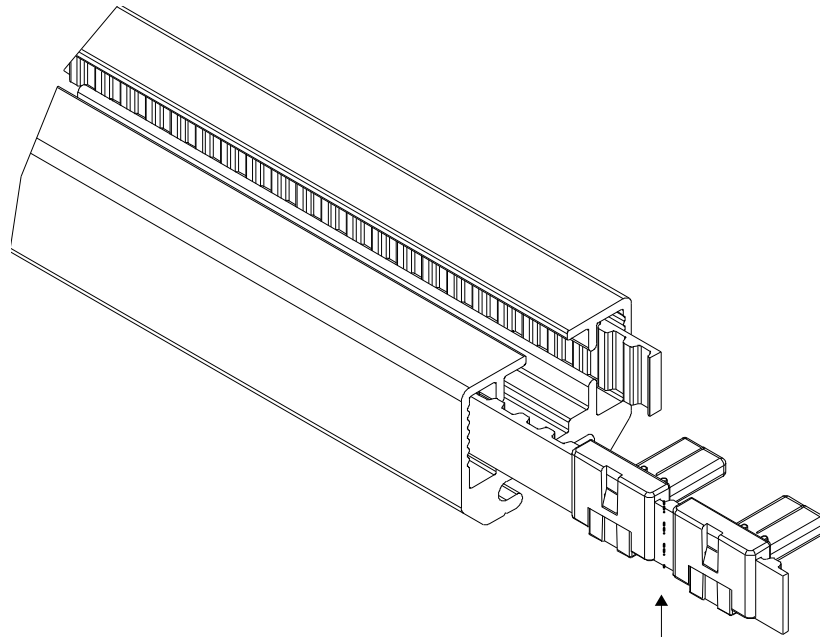

Place belt clip on either side of the mark.

5. Reattach the second master carrier by sliding it onto the two belt clips. Slide the master carrier into the track.

Slide Master Carrier into Track

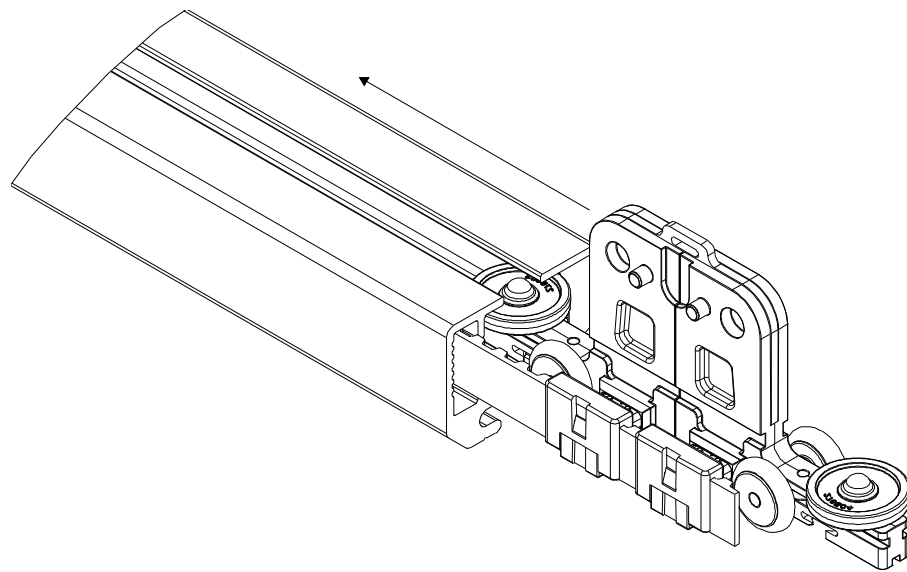

6. Slide the idler pulley onto the idler end of the track. Ensure that the track is fully seated inside the pulley.

Idler Pulley onto the Track

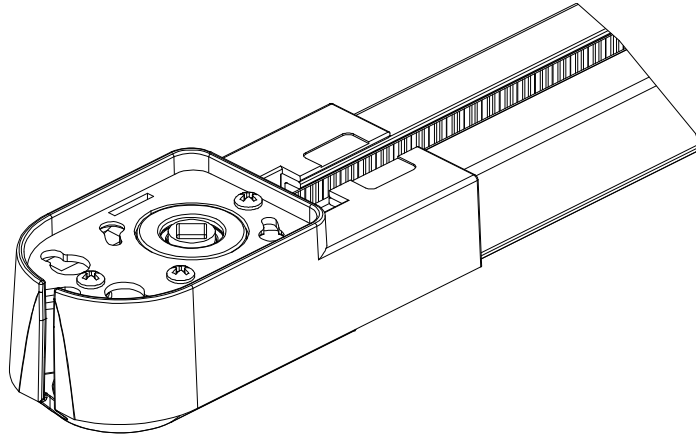

7. On the drive end of the track, orient the drive side pulley to align with the track. Then, slide the loose end of the belt through the pulley.

Slide the Belt Through Drive Pulley

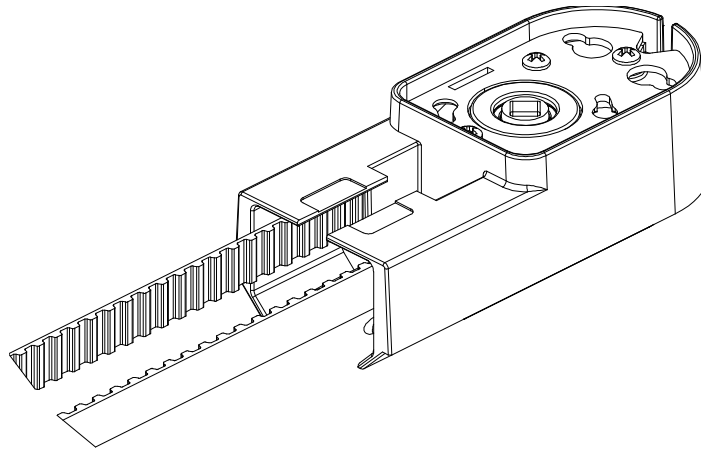

8. Place the belt clip onto the end of the loose end of the belt. Then, slide the clasp onto the clip.

NOTE: All teeth on the belt clip must engage with the teeth on the belt.

Place Belt clip on the Belt

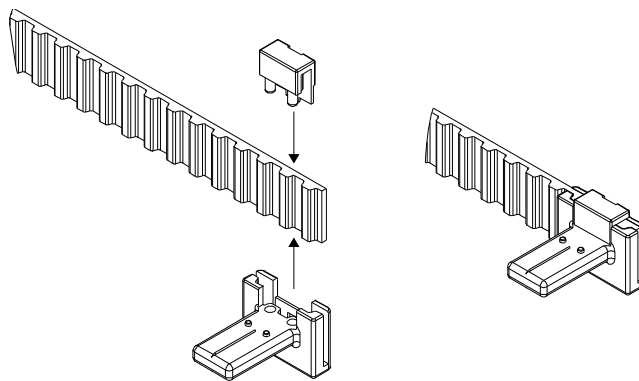

9. Place the master carrier on the belt clip and slide it into the track.

Slide Master Carrier into Track

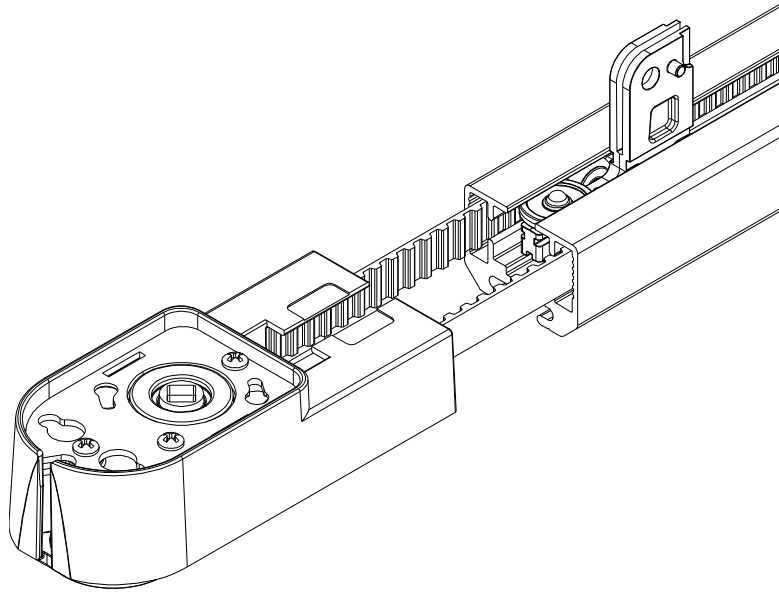

10. Slide the drive pulley onto the drive end of the track. Ensure that the track is fully seated inside the drive pulley.

Insert End of Track into Drive Pulley

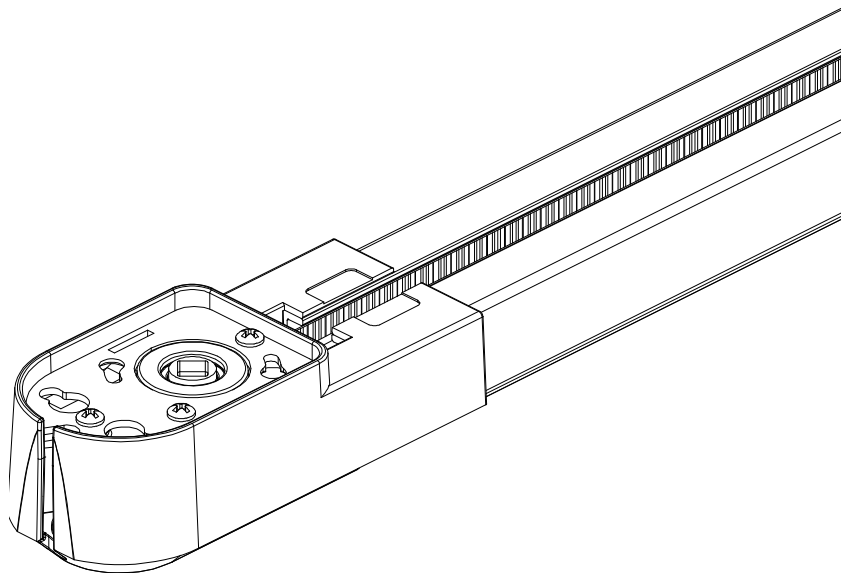

11. Insert the carriers into the track. All carriers must be installed so that the slot faces the room once the track is installed.

Insert Carriers into the Track

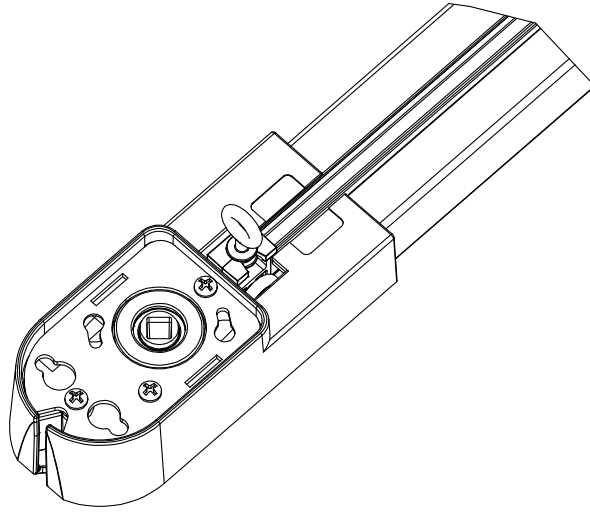

Slide Carriers into Track

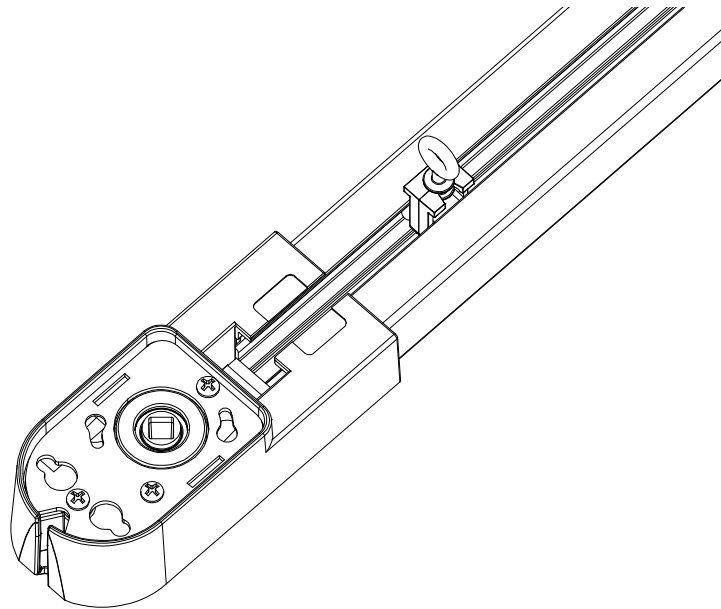

12. Attach the bumpers at each end of the track as shown. The rubber pads must lay inside and point into the track at each end.

Attach Bumpers (Drive Pulley Side Shown)

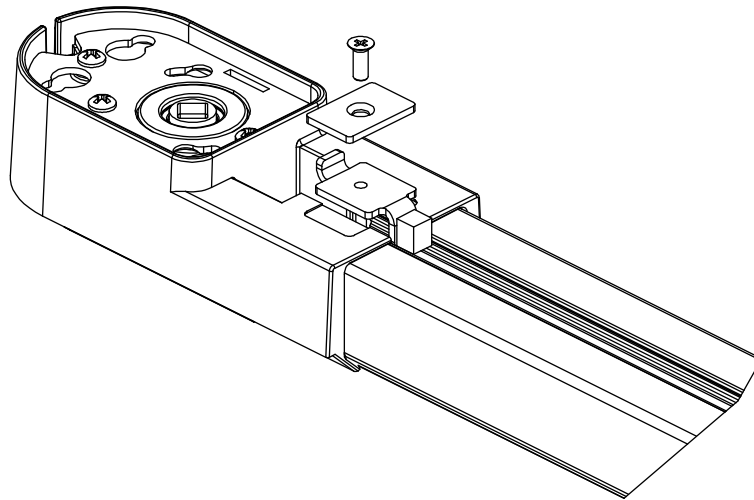

Assemble the Master Carrier and Arm

After the track and belt has been cut, assemble the master carrier(s) and arm(s).

1. Slide each half of the master carrier toward each other and secure them using the joining plate.

Secure the Master Carrier with the Joining Plate

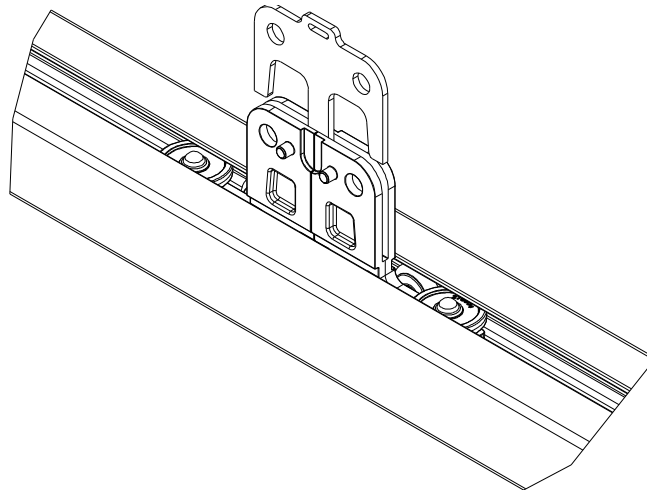

2. Place the nut plate over the pins on the master carrier. The wheel bearing should face the window and point toward the drive pulley for right or left draw and point toward the idler pulley for center draw. The wheel bearing for a center draw application should point toward the drive and idler pulleys respectively.
3. Secure the arm by installing the two screws through the nut plate.

Align Arm and Wheel Bearing Arm with Master Carrier

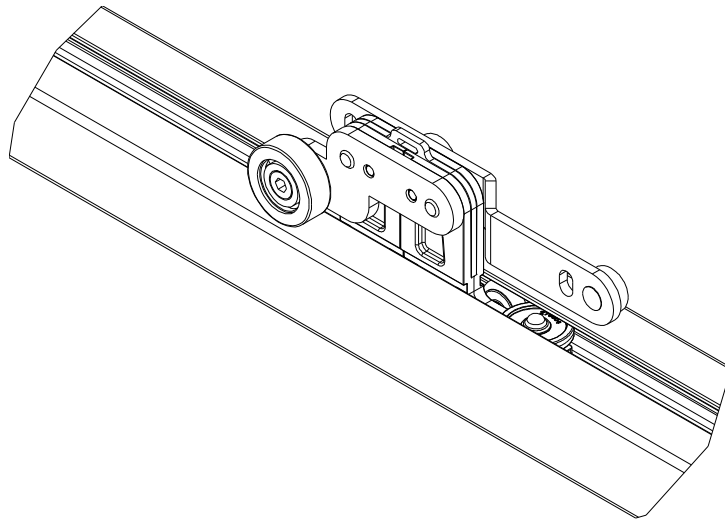

Screw Arm onto Master Carrier

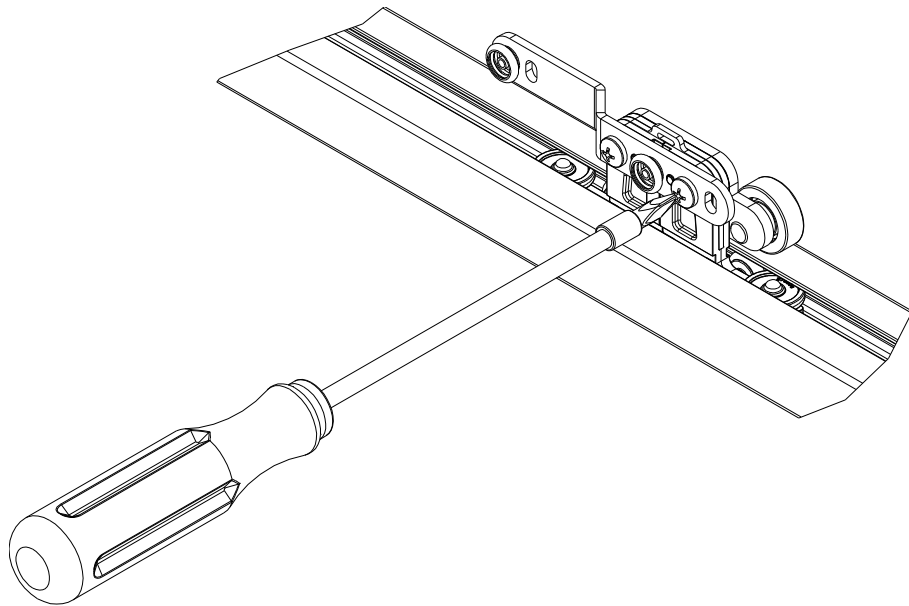

NOTE: For split-draw assembly, refer to the following images depending on the type of arm used for the installation.

Pinch Pleat Extended Overlap Arm

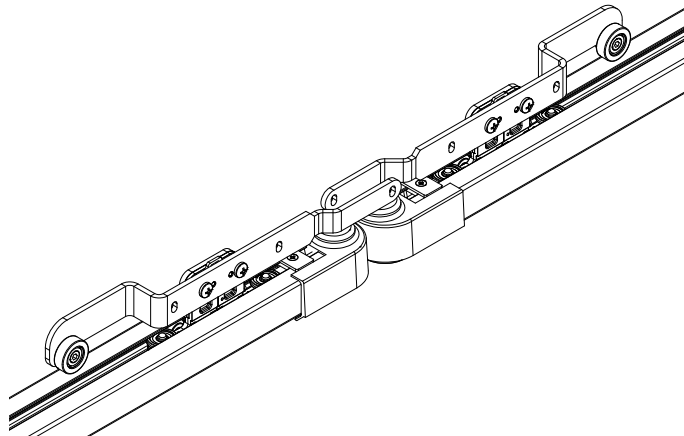

Pinch Pleat Extended Arm

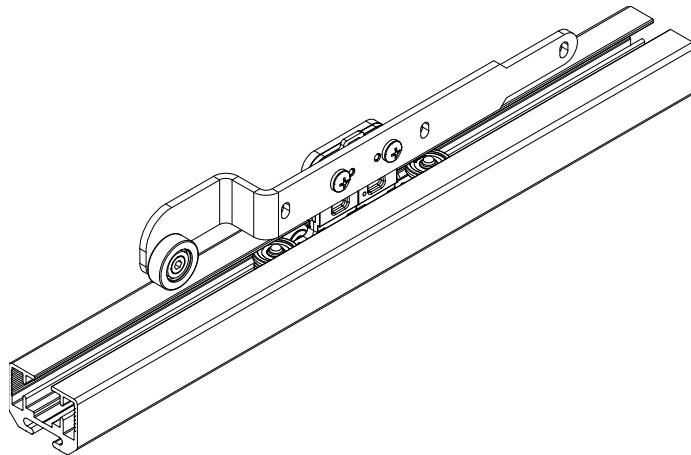

Ripplefold Extended Overlap Arm

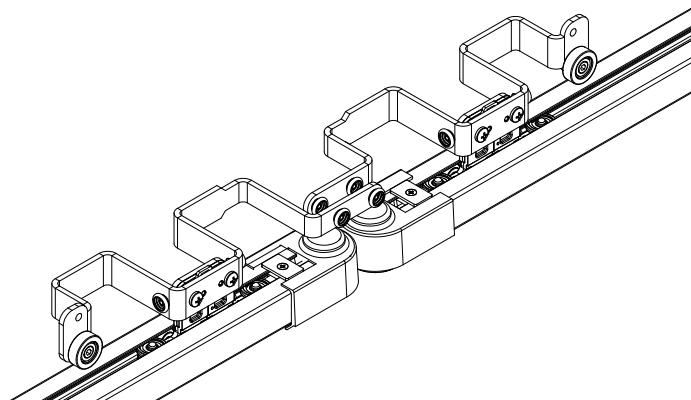

Center Draw Overlap Arm

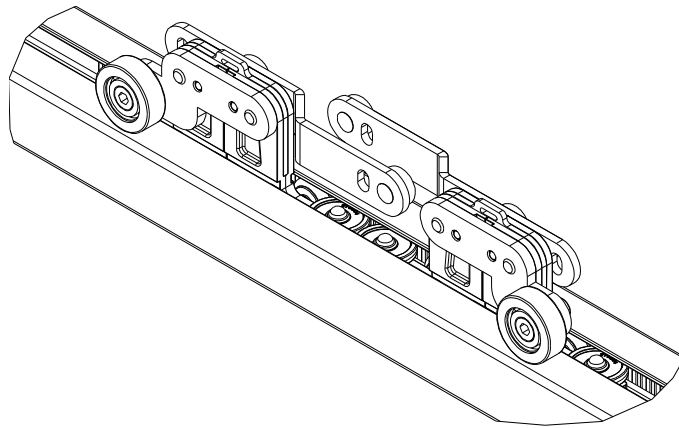

Butt Master Arm

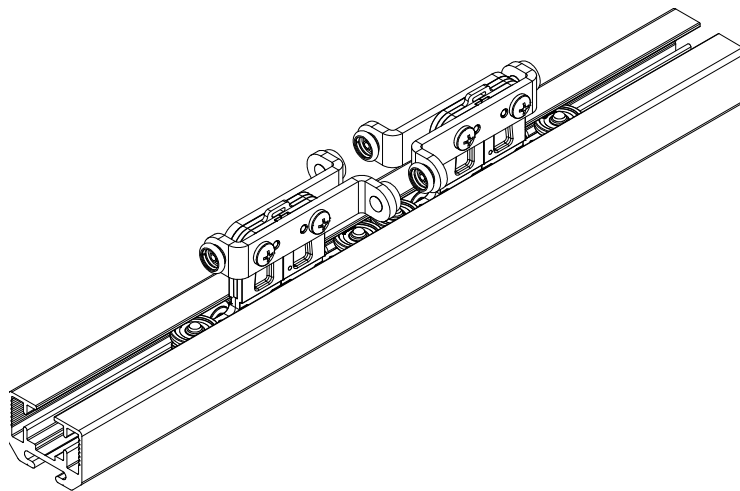

One-Way Butt Master Arm

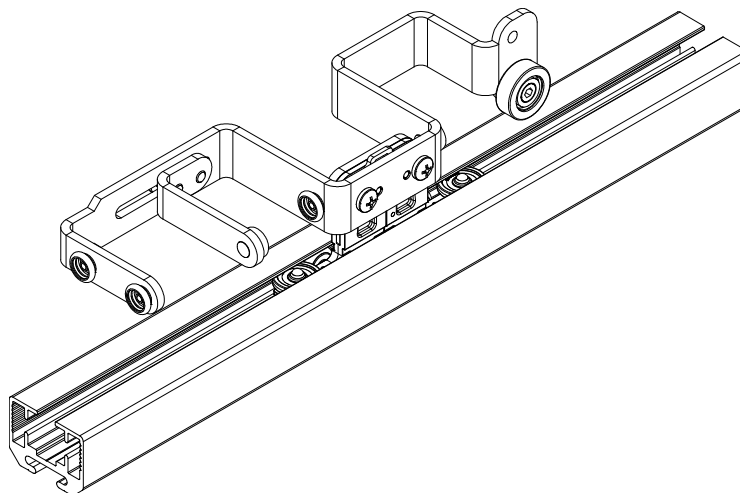

This page is intentionally left blank.

Crestron Electronics, Inc.
15 Volvo Drive Rockleigh, NJ 07647
Tel: 888.CRESTRON
Fax: 201.767.7576
www.crestron.com



Reference Guide – DOC. 7835A
(2045125)
05.17
Specifications subject to
change without notice.